

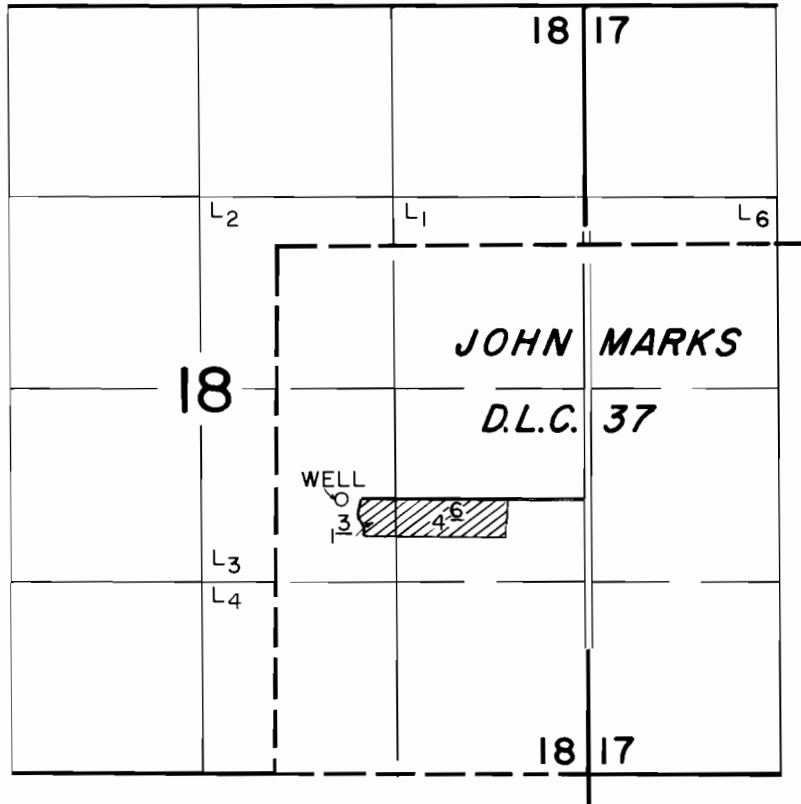

T. 4 S., R. 1 E., W. M.



WELL LOC: 1890' N. & 1680' W. FROM THE SE. CORNER SEC. 18

SCALE: 1" = 1320'

FINAL PROOF SURVEY
UNDER

Application No. G-9712. Permit No. G-8863....
IN NAME OF

RAYMOND M. & MARGARET H. ROWSELL

Surveyed JULY 1, 1985, by T. WARREN.....