

T. 5 S., R. 1 E., W.M.

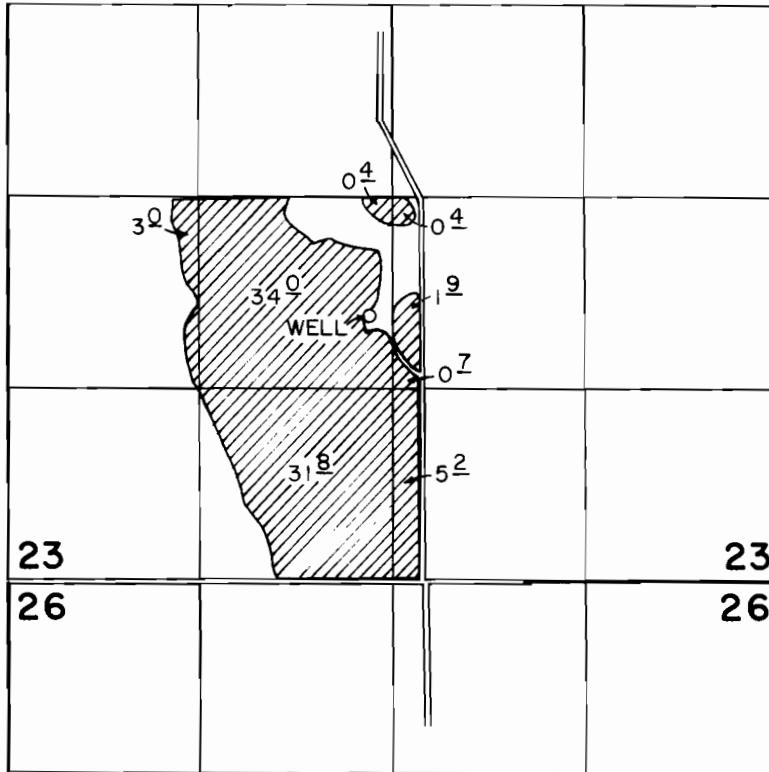

WELL LOC: 1800' N. & 2800' W. FROM THE SE. CORNER SEC. 23

SCALE: 1" = 1320'

FINAL PROOF SURVEY UNDER

Application No. G-10217. Permit No. G-9252....
IN NAME OF

.....ELTON D. KEMNITZ.....

Surveyed JUNE 25, 1985, by T. WARREN.....