

G-9238
54249

T. 39S., R. 19E., W. M.

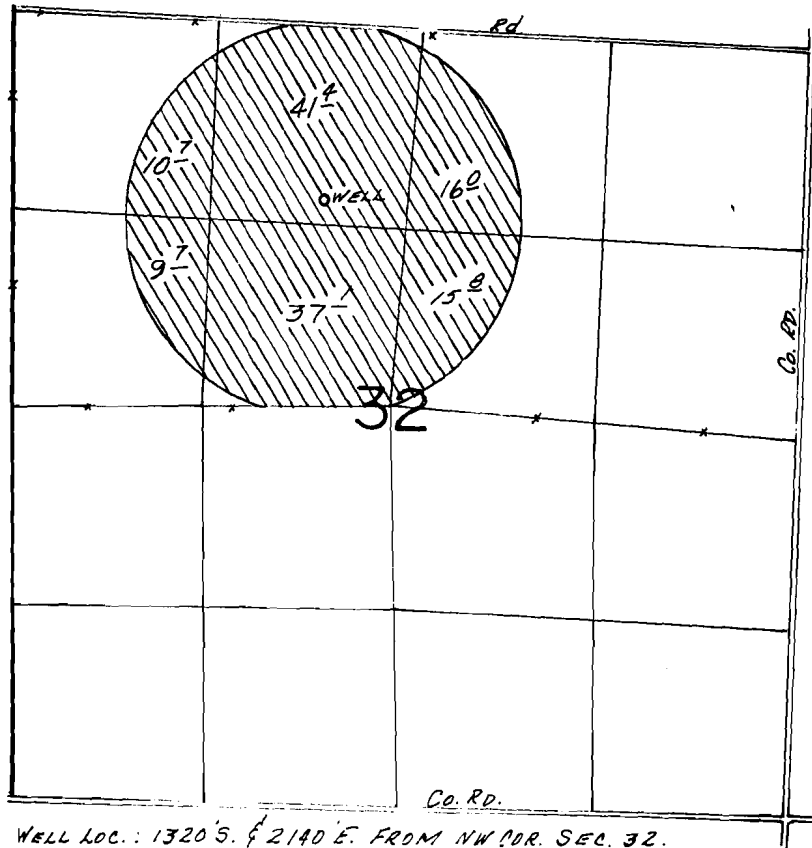

WELL LOC.: 1320'S. & 2140'E. FROM NW COR. SEC. 32.

SCALE: 1" = 1320'

FINAL PROOF SURVEY UNDER

Application No. G-10203 Permit No. G-9238.....

IN NAME OF

.....ROBERT M. PARDUE.....

Surveyed June 22, 1984, by B.W. BISHOP.....