

APP. 10036

66696
5429
48716

MAP
Application of JESSE L. NEIL of
Co. Ore. for permit to the waters
of Grizzly Cr., Hoxie Cr., Willow Cr., Spring
Jackson Co. Ore. all tributary to
Klamath River for the pur-
pose of irrigation on lands as shown on plat.
March 11th 1925.

Survey in the field made by
Fred N. Cummings C.E.
The same correctly showing
diversions, lands to be irrigated
streams in immediate vicinity

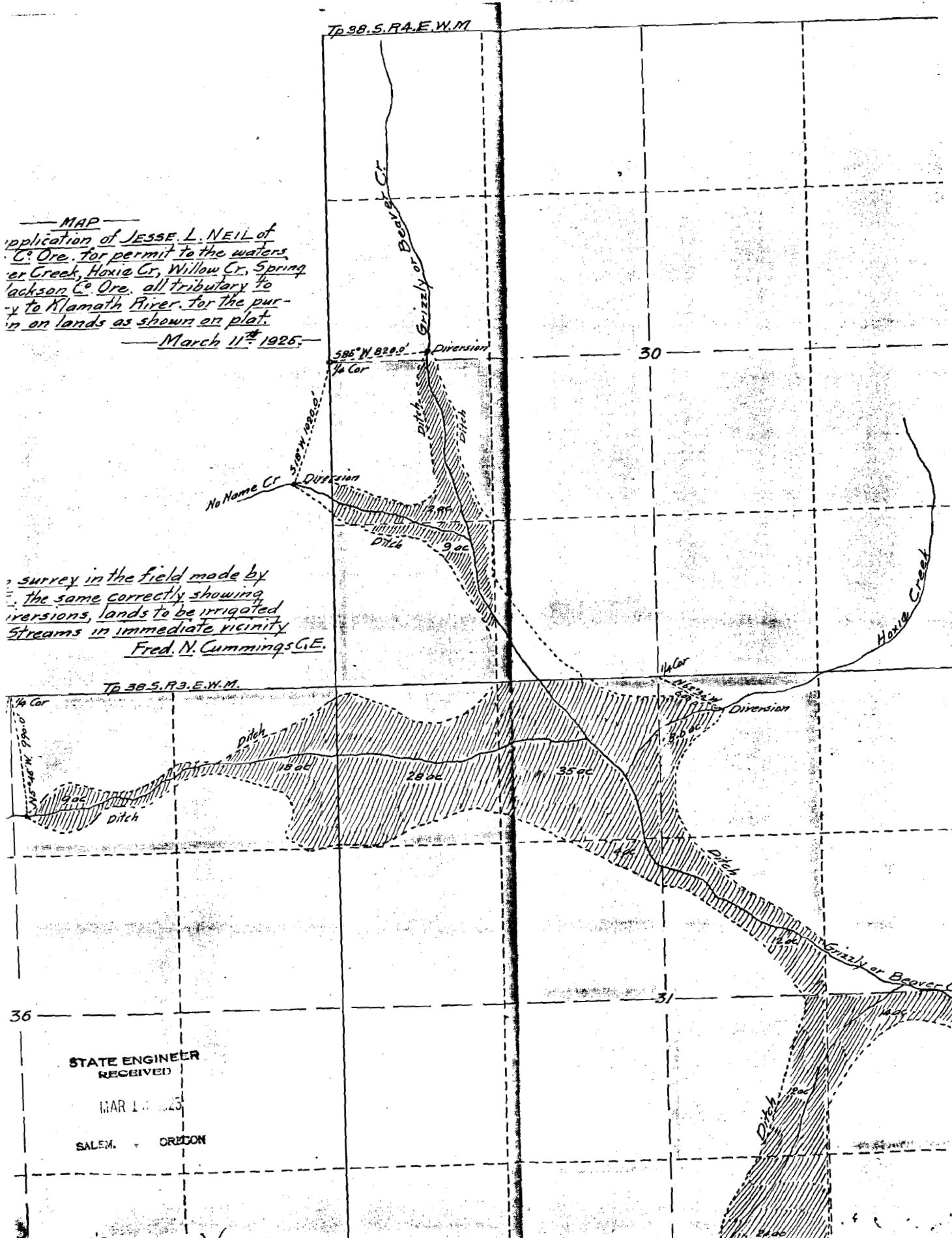

STATE ENGINEER
RECEIVED
MAR 11 1925
SALEM, OREGON

Grizzly Cr. : misc.