

T. 30S., R. 5W., W.M.

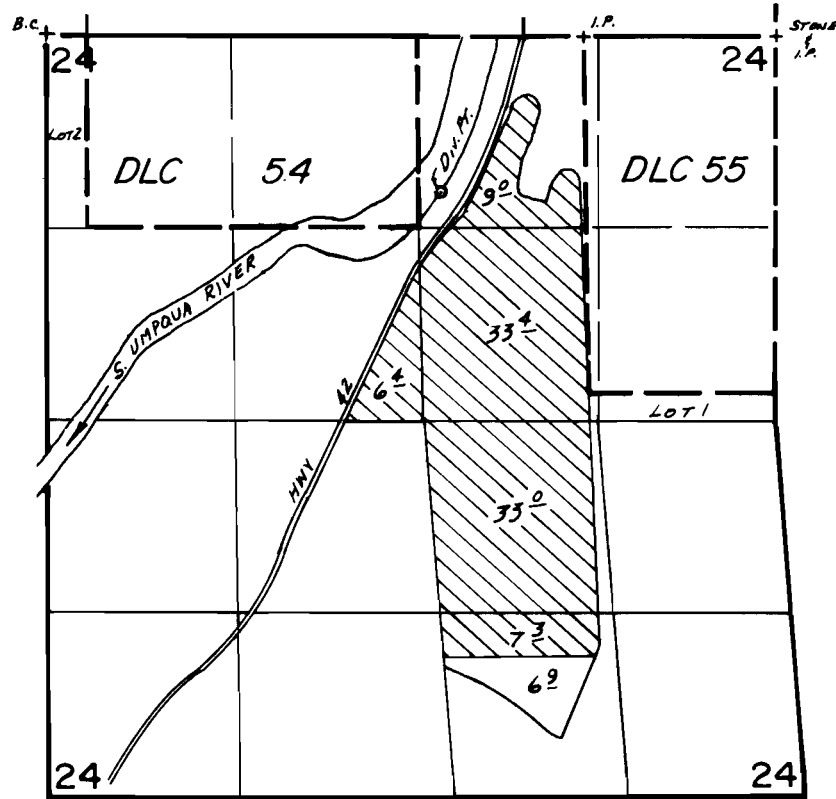

Div. Pt. Loc.: 1070'S. & 2290'W. FROM NE COR. SEC. 24.

FINAL PROOF SURVEY
UNDER

Application No. 51148... Permit No. 38806.....
IN NAME OF

DEAN A. & MARGARET R. BROOKEY

Surveyed JUNE 25, 1980., by J.S. DONALDSON