

—MAP—

Accompanying application of F. R. SCHULTZ of Medford Oregon. for permit to the waters of Star Gulch Tributary of Big Applegate River, Jackson County, Oregon. for the purpose of Placer Mining.

—March, 1921.—

Tp 39.S.R.3 W.W.M.

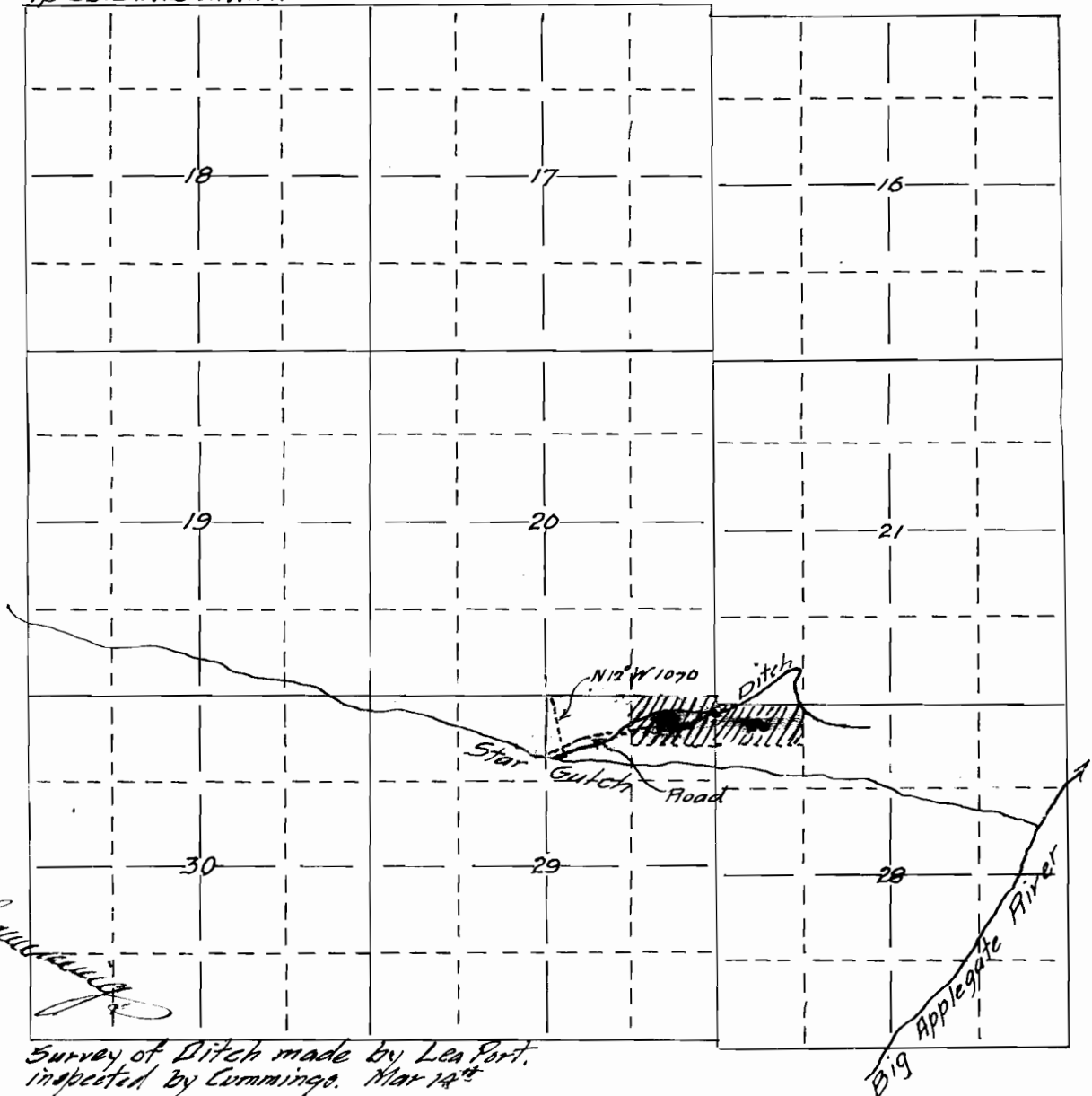

Survey of Ditch made by Lea Fort,  
inspected by Cummings. Mar 19<sup>th</sup>

Map made from survey made for F. R. Schultz correctly showing the Mining claims together with streams and ditches in immediate vicinity. compiled by  
Fred. N. Cummings. C.E.

550  
4986