

T. 27S., R. 3W., W.M.  
SEC. 2

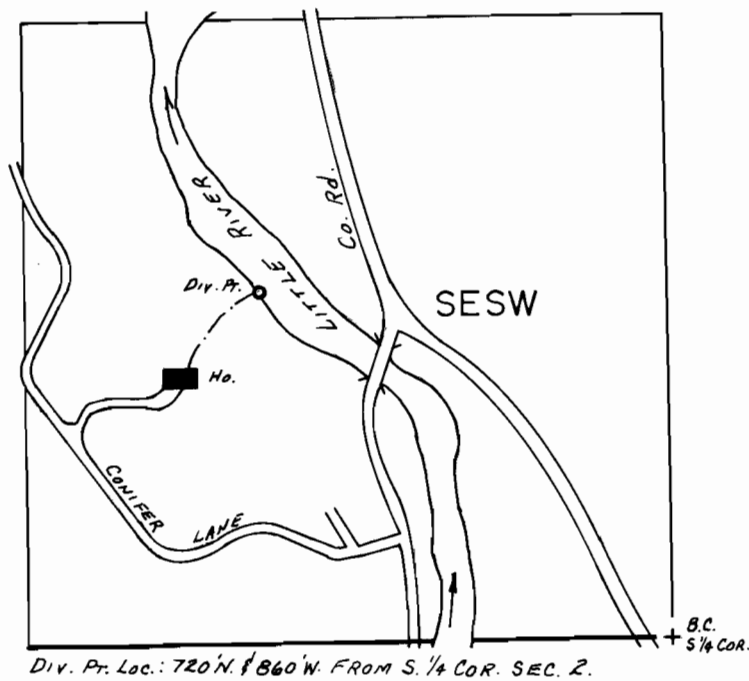

SCALE: 1" = 400'

**FINAL PROOF SURVEY**  
UNDER

Application No. 57956 Permit No. 43596  
IN NAME OF

THEODORE F. GORDON

Surveyed MAY 13 1980, by J. S. DONALDSON

*PW*