

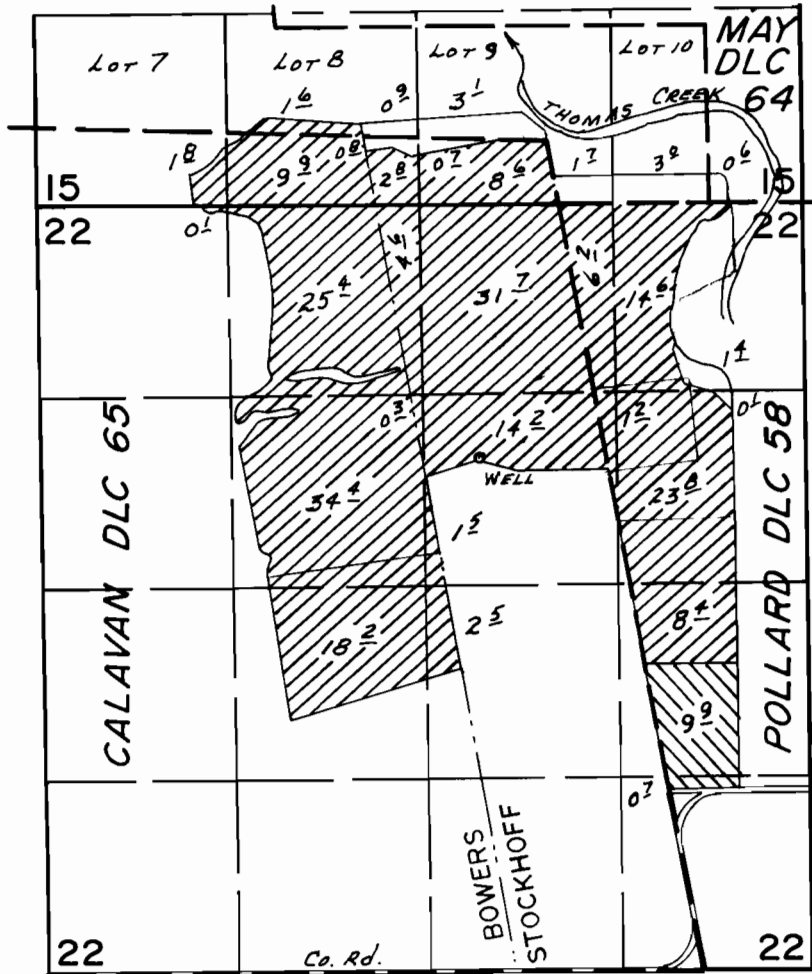

T.10S., R.2W., W.M.



WELL LOCATED 3520' N. & 1450' W. FROM SE COR. DLC 65

-  PRIMARY
-  SUPPLEMENTAL

FINAL PROOF SURVEY UNDER

Application No. G-7879. Permit No. G-7294.....
IN NAME OF

.....ROBERT L. STOCKHOFF.....

Surveyed JULY 6, 1982, by L.M. TOLL.....