

T.9S.,R.3W.,W.M.

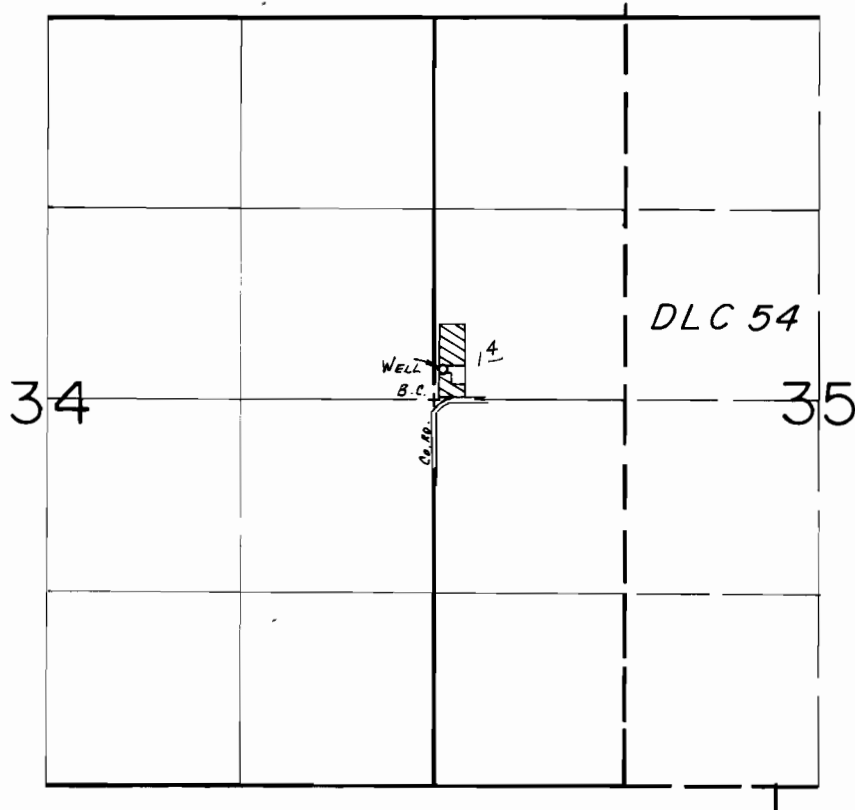

WELL LOC.: 200' N. 60' E. FROM W 1/4 COR. SEC. 35.

SCALE: 1"=1320'

**FINAL PROOF SURVEY**  
UNDER

Application No. G-10840 Permit No. G-9995.....  
IN NAME OF

.....DONALD & DONNA MEHLHORN

Surveyed May 3..... 1985, by ..P.R. PATER.....