

T.2N.R.1W.W.M.

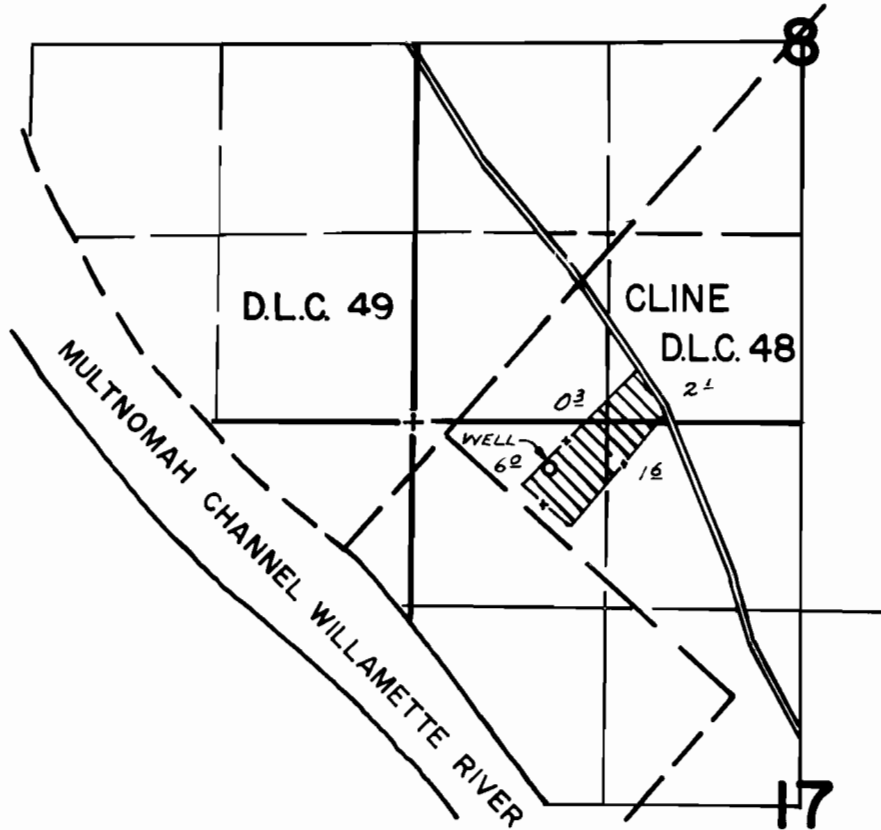

WELL LOC: 310' S. & 930' E. FROM N.W. COR. SEC. 17

FINAL PROOF SURVEY
UNDER

Application No. G-8767 Permit No. G-8291
IN NAME OF

John R. and Susan M. Barker

Surveyed NOV. 8, 1979, by R. G. MUCKEN