

T.1&2S., R.25E. W.M.

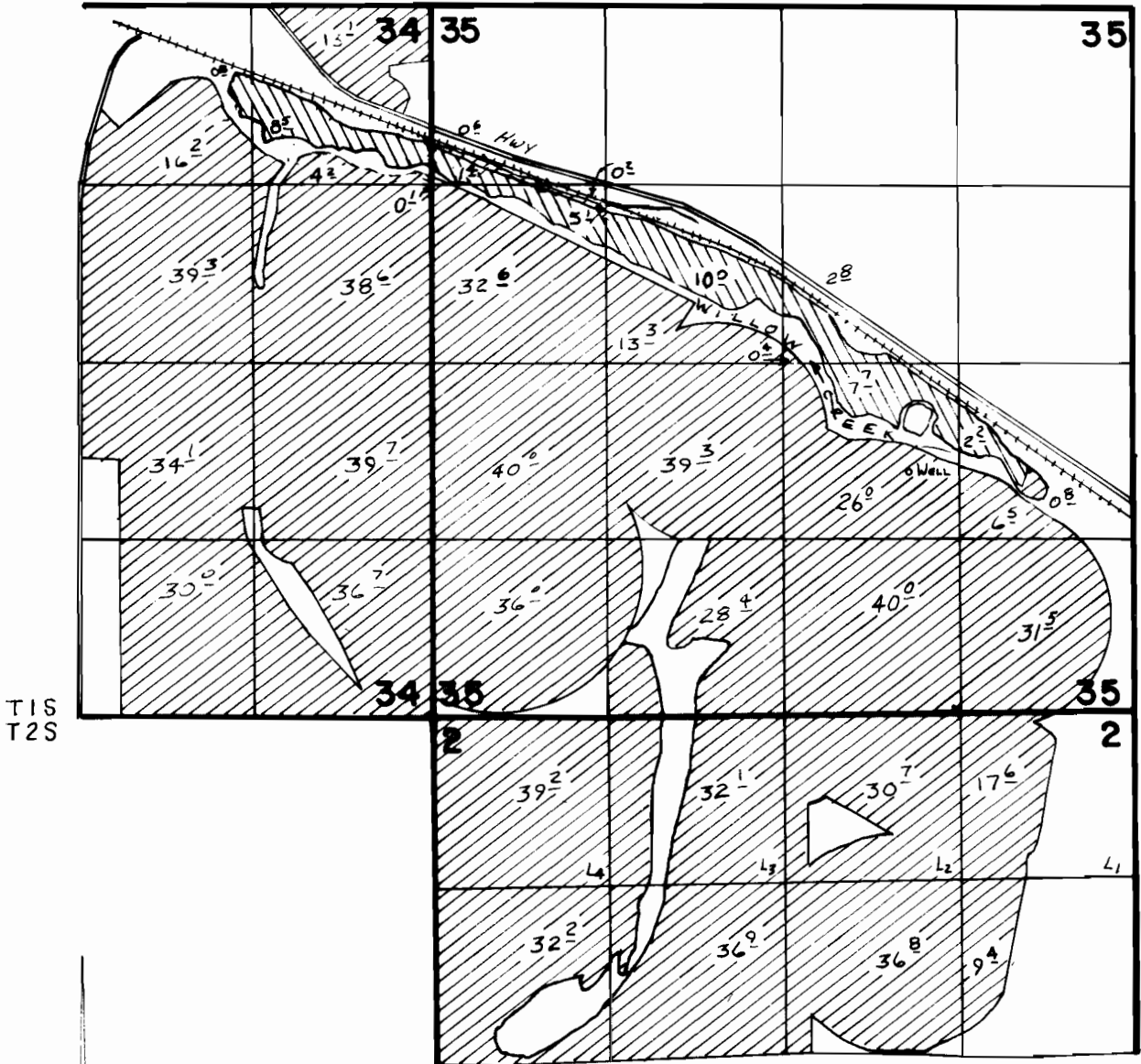

T1S
T2S

WELL LOC: 1810' N. + 1680' W. FROM SE COR SEC 35

 PRIMARY
 SUPPLEMENTAL

FINAL PROOF SURVEY UNDER

SCALE: 1" = 1320'

Application No. **G-6085**. Permit No. **G-6028**....
IN NAME OF

..... **ELMER E. PADBERG**

Surveyed **JUN. 14**..... 19**83**., by *U. L. Amundson*.....