

*Map of Pipe Line from Skelton Spring
To City of Newberg.*

*I, Oliver Weesner, of Newberg, Oregon,
do hereby certify that this map
was made from deeds, plat of Newberg,
plat of a survey made by Sylvander
Simms August 26, 1911, and records
of Yamhill Co. Oregon.*

Aug. 1, 1923.

Oliver Weesner.

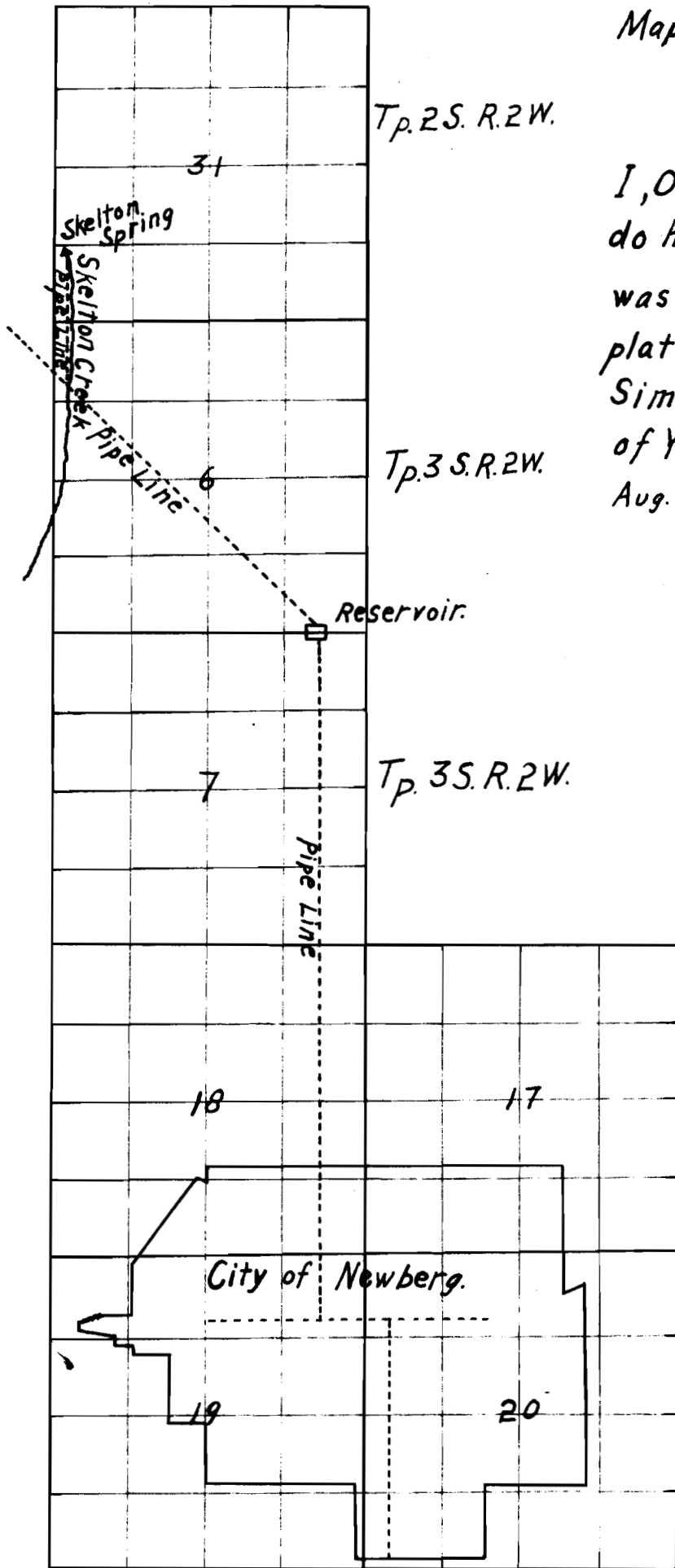

Application No. 6604
Permit No. 5977

Tp. 3 S. R. 2 W.

STATE ENGINEER
RECEIVED

AUG 2 1923

SALEM, OREGON

Tp. 3 S. R. 2 W.