

T. 6N., R. 35E., W.M.

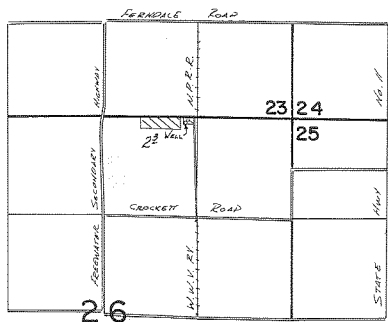

WELL LOC: 70'S F 1460' W. FROM NE COR. SEC. 26

FINAL PROOF SURVEY
UNDER

Application No. G-9400 Permit No. G-8801

IN NAME OF

ERNEST & NINA SILVASurveyed Sept. 8 1982, by V.L. Church