

T. 5N., R. 29E., W.M.

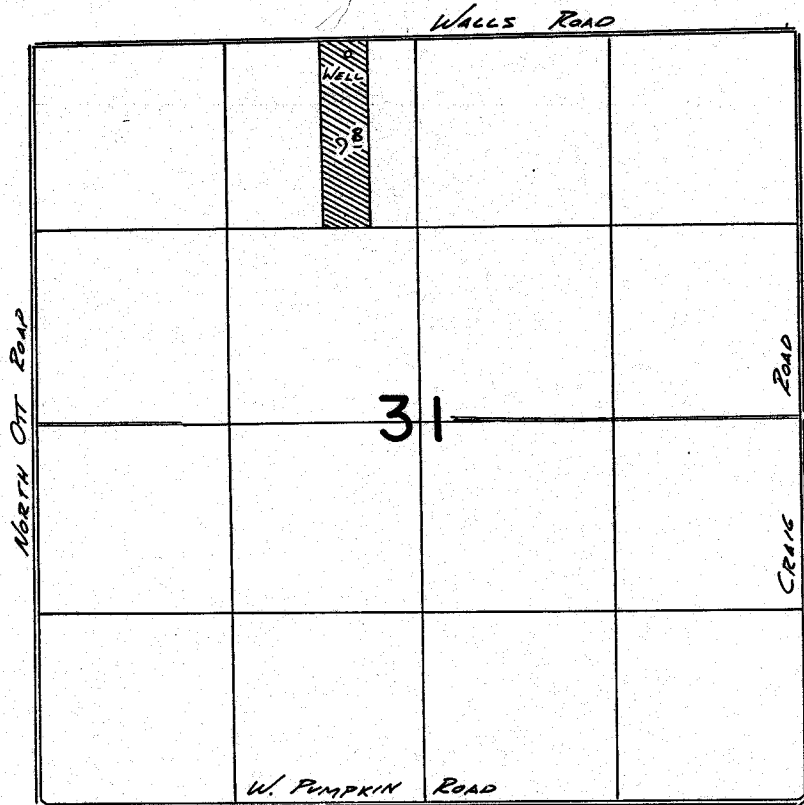

WELL LOC: 100'S. + 460'W. FROM N 1/4 COR SEC 33

**FINAL PROOF SURVEY**  
UNDER

Application No. **G:10316** Permit No. **G:9418**  
IN NAME OF

**RONALD A. & SUSAN M. WILLIAMS**

Surveyed *Nov. 30* 1982, by *J.H. Church*