

T.28S.,R.6W.,W.M.

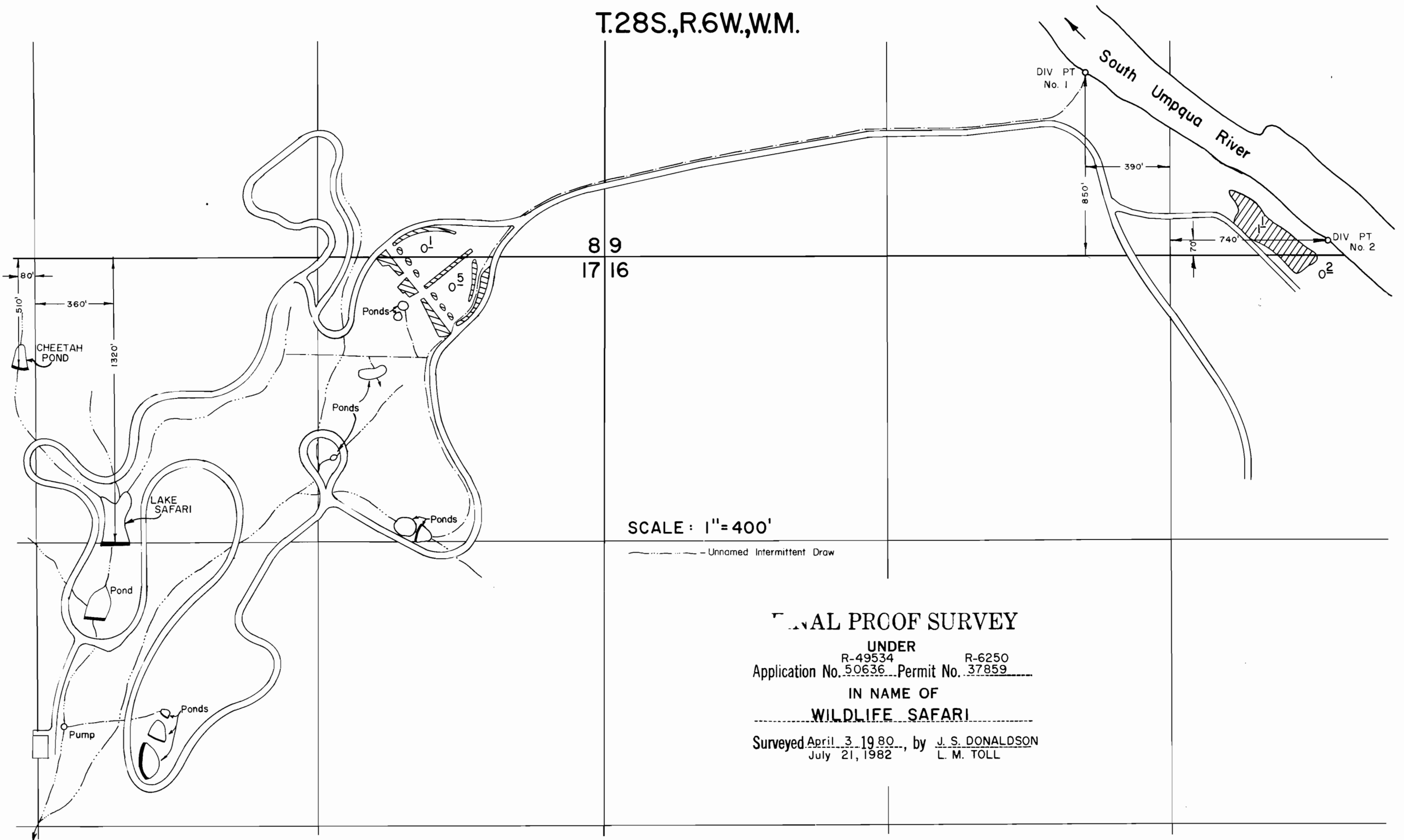

SCALE: 1" = 400'

----- Unnamed Intermittent Draw

FINAL PROOF SURVEY

UNDER
 R-49534 R-6250
 Application No. 50636 Permit No. 37859

IN NAME OF
 WILDLIFE SAFARI

Surveyed April 3, 1980, by J. S. DONALDSON
 July 21, 1982, by L. M. TOLL