

T. 29S., R. 4W., W.M.

5

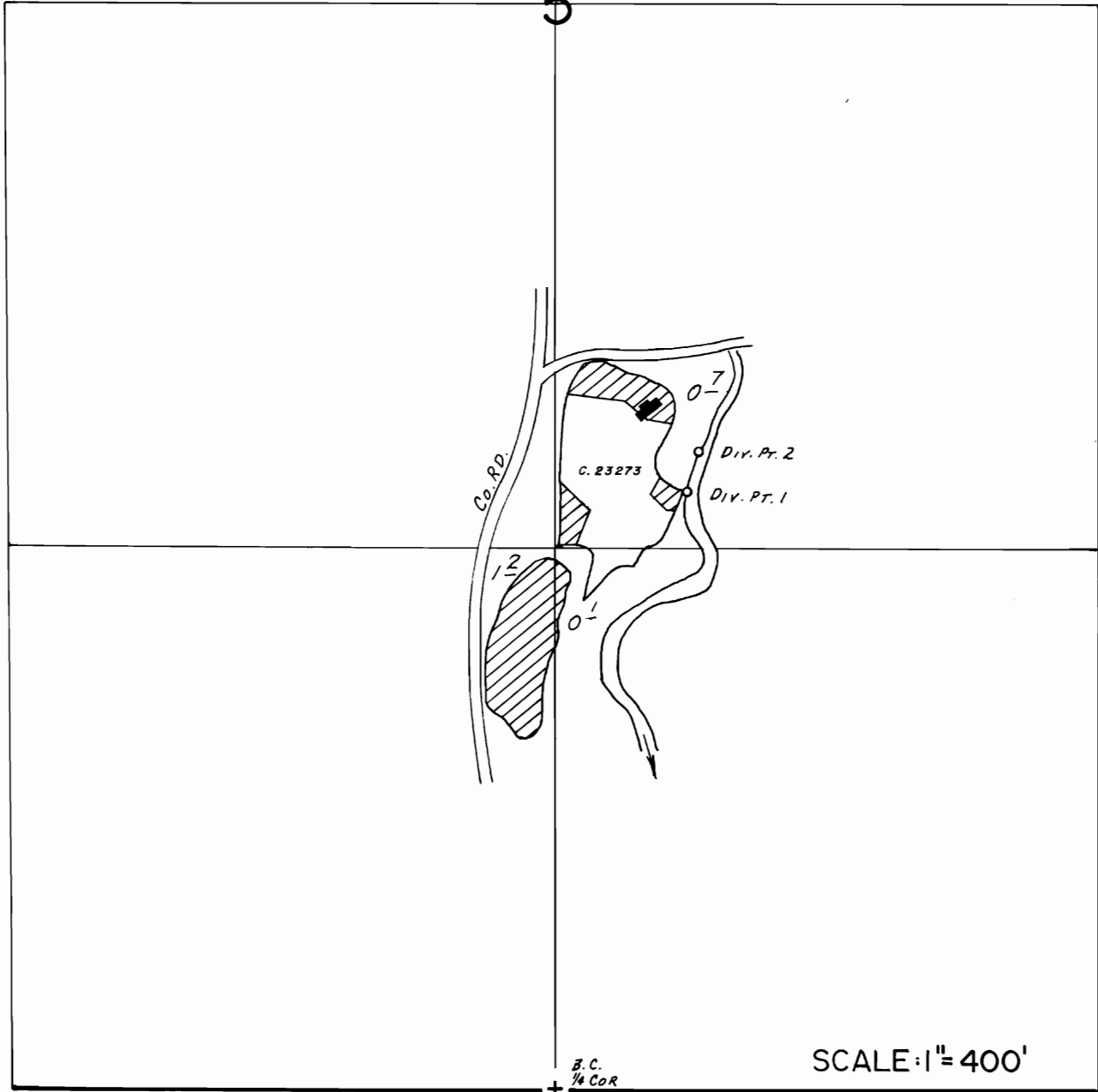

SCALE: 1" = 400'

Div. Pts. Loc.: #1- 1460' N. & 320' E.; #2- 1550' N. & 350' E., BOTH FROM S 1/4 COR. SEC. 5.

FINAL PROOF SURVEY
UNDER

Transfer No. 4142
Application No. 54598.. Permit No. 40967.....
IN NAME OF

... G. F. & GLADYS L. PATTERSON.

Surveyed JUNE 10, 1980, by J.S. DONALDSON.