

T.26S., R.2W., W.M.

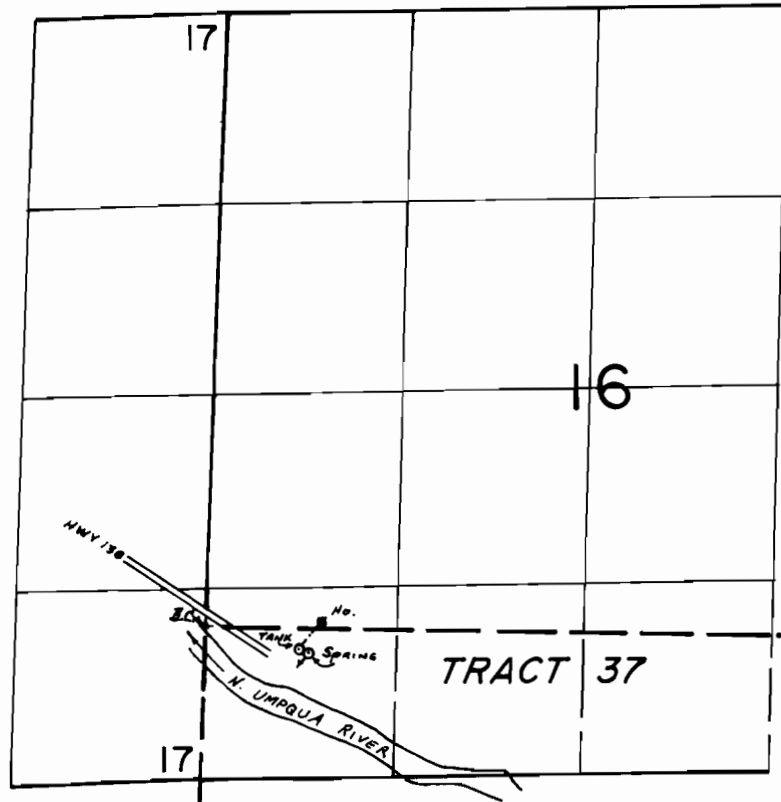

SPRING LOC.: 180'S. & 700'E. FROM NW COR. TRACT 37.

FINAL PROOF SURVEY
UNDER

Application No. 54775.. Permit No. 41232.....
IN NAME OF

..... JAMES A. & JEAN P. HOWARD

Surveyed MAY..5..... 1980., by J.S. DONALDSON