

T. 38S., R. 3W., W.M

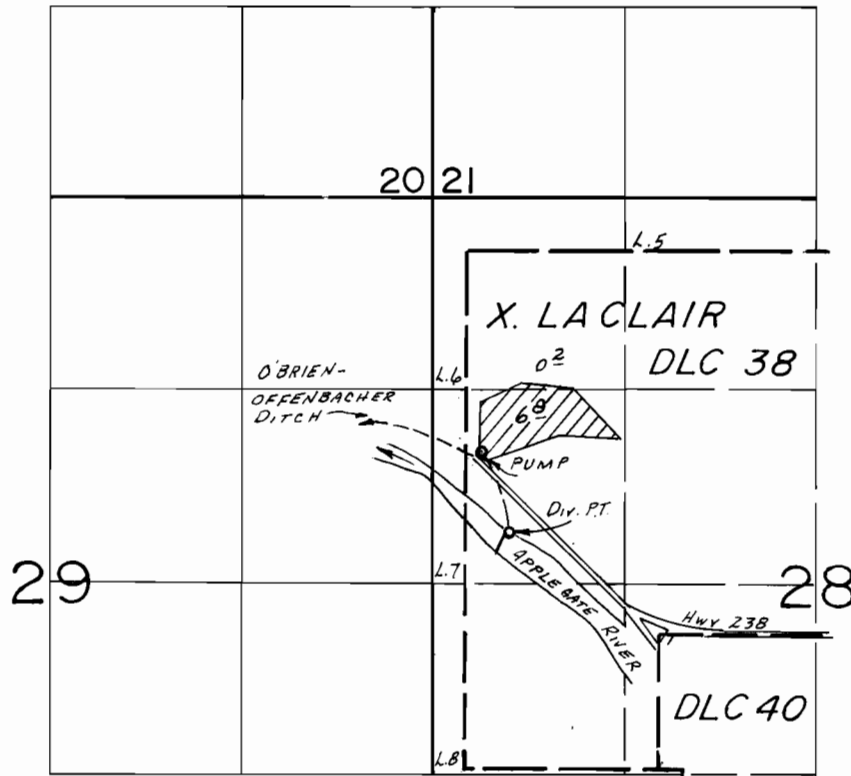

Div. Pt. Loc.: 2310'S. & 520'E. FROM NW COR. SEC. 28.

SCALE: 1" = 1320'

FINAL PROOF SURVEY UNDER

Application No. .63516... Permit No. .47.127.....
IN NAME OF

RANDI H. &/OR SUSAN K. LUMMIS.

Surveyed June.11... 19.85, by B.S. JAMES.....