

T3S. R1E. WM.

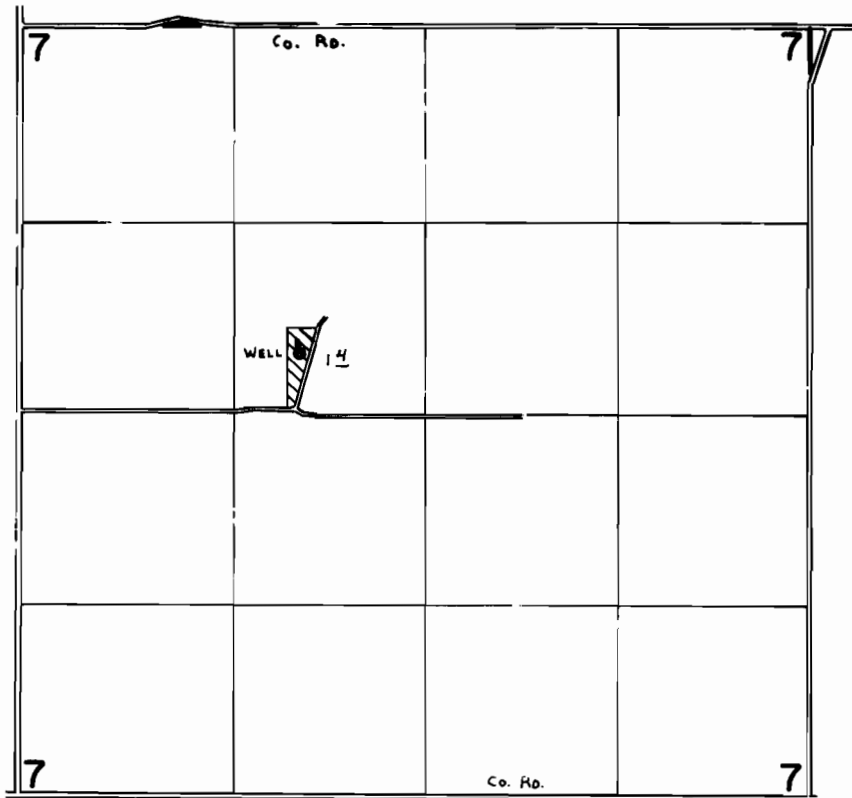

WELL Loc: 410' N. & 1920' E. fr. W. 1/4 COR. SEC. 7.

FINAL PROOF SURVEY UNDER

Application No. G-8081 Permit No. G-7475
IN NAME OF

RICHARD F. BURDON

Surveyed JUNE 5 1978, by C. L. HUGHES