

T. 7S., R. 38E., W.M.

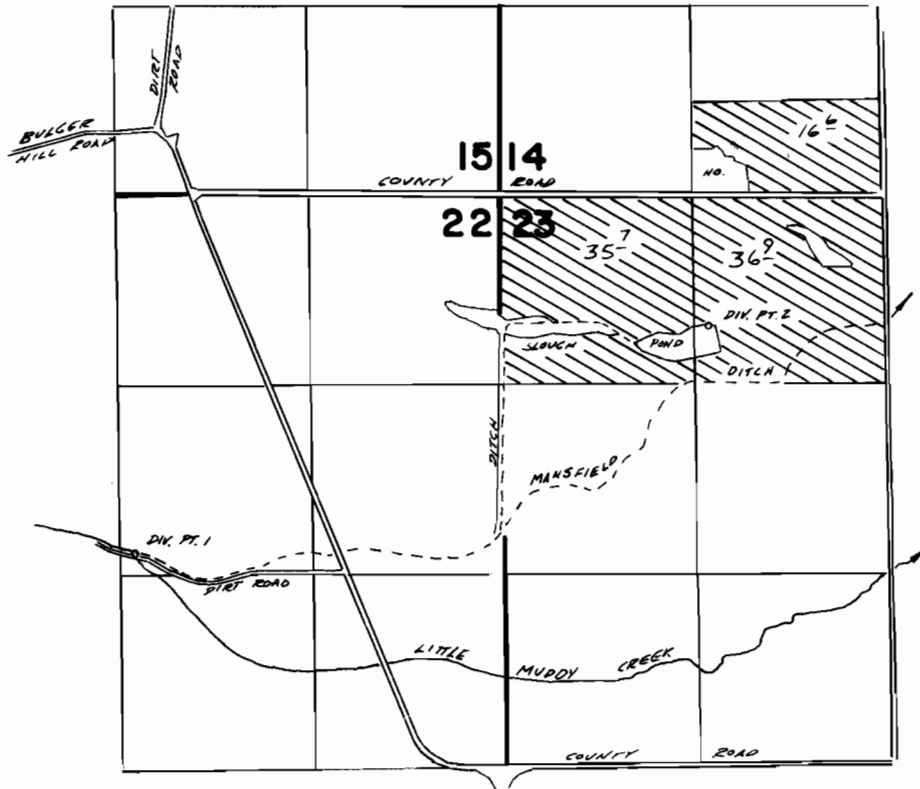

DIV. PT. 1 LOCATED 2470' S. & 2540' W. FROM NE COR. SEC 22

DIV. PT. 2 LOCATED 870' S. & 1400' E. FROM NW COR. SEC. 23

**FINAL PROOF SURVEY**  
UNDER

Application No. **55453** Permit No. **42037**...  
IN NAME OF

**JOSEPHINE J. JENSEN**

Surveyed 4-14..... 1982., by *Norman Lee Church*