

G-5909

54733

T. 4N., R. 28E., W.M.

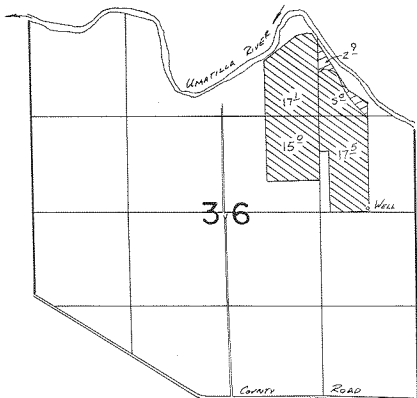

WELL LOC: 50' N. + 65' W. FROM E 1/4 COR. SEC 36

FINAL PROOF SURVEY
UNDER

	SUPPL.
	PRIMARY

Application No. G:6277. Permit No. G:5909
IN NAME OF

.....FRANK.....MUELLER.....

Surveyed JULY 28. 1982. by *V.L. Church*.....