

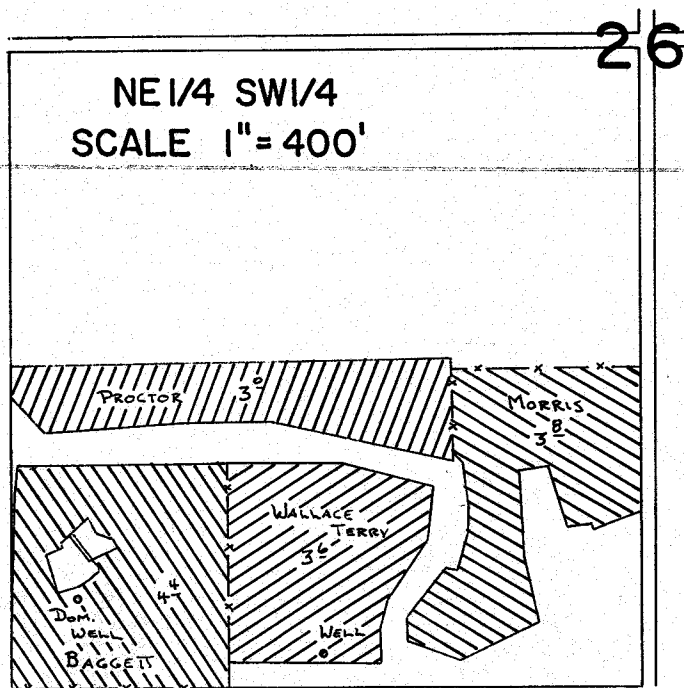



6-6974  
S4737

T. 5N., R. 28E., W.M.



WELL LOCATED 1250' S. & 670' W. FROM CENTER COR. SEC. 26

- MORRIS 
- PROCTOR 
- TERRY 
- BAGGETT 

**FINAL PROOF SURVEY**  
UNDER

Application No. G:7547 Permit No. G:6974  
IN NAME OF

LELAND R. BAGGETT

Surveyed May 4, 1984, by L. G. Church