

T. 31S., R. 4W., W.M.

SEC. 33

NWSE

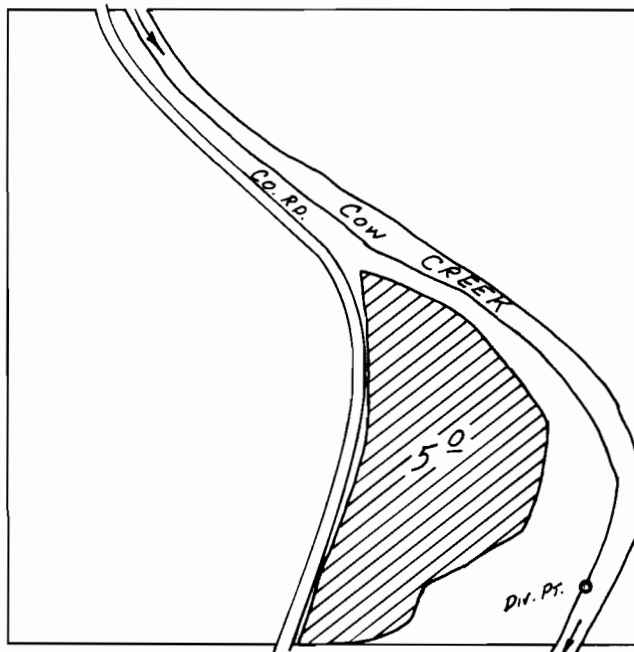

Div. Pt. Loc.: 1200'S. & 1200'E. FROM C. 1/4 COR SEC. 33

SCALE: 1" = 400'

FINAL PROOF SURVEY

UNDER

Application No. 54570... Permit No. 40949.....

IN NAME OF

WALLACE G. & IMOGENE J. SCOTT

Surveyed JULY 7, 1980, by J.S. DONALDSON