

# T9S RIE WM

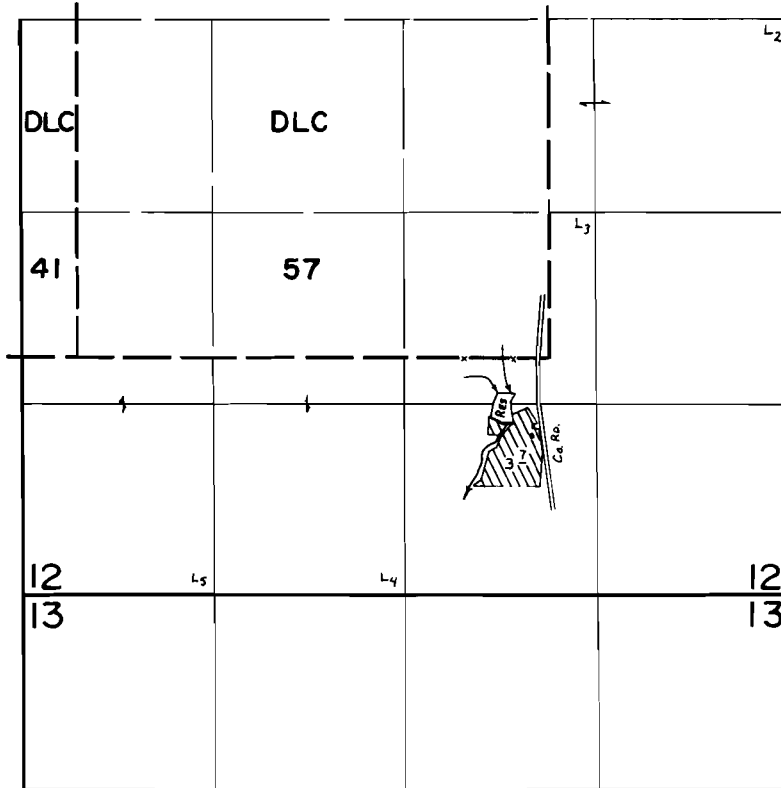

DAM Loc: 450'S. & 300'W. fr. S.E. COR. FITZGERALD DLC. 57.

## FINAL PROOF SURVEY UNDER

R-53854                      R-6448  
 Application No. 54027... Permit No. 40477...  
 IN NAME OF

MELVIN L. HALL

Surveyed APR 25 1980, by C. L. HUGHES