

T.36 S. R.3 W. W.M.

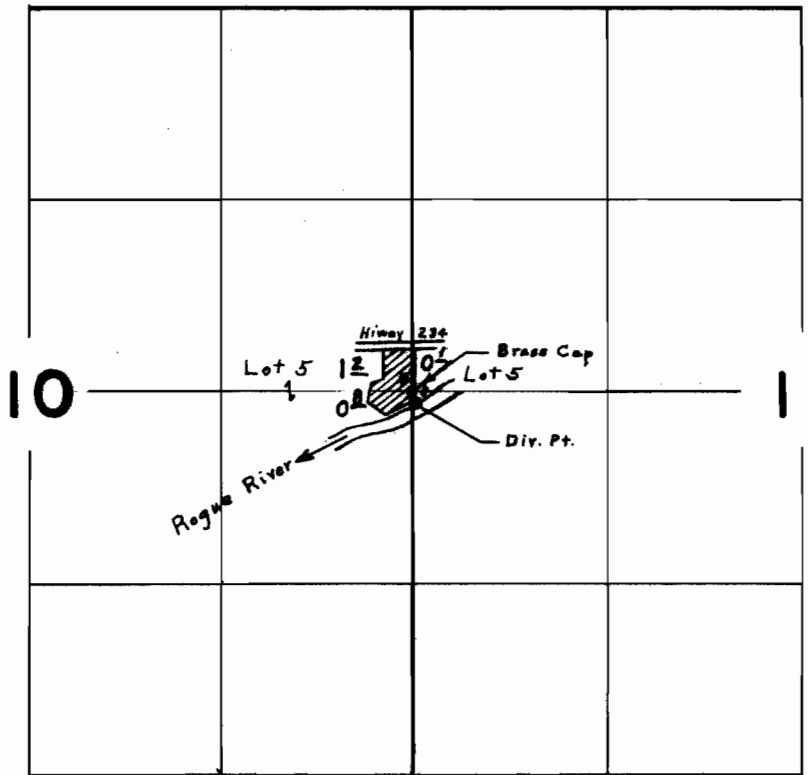

Div. Pt. Located 20' E. & 80' S. From E. $\frac{1}{4}$ Cor. Sec. 10

FINAL PROOF SURVEY
UNDER

Application No. 34271. Permit No. 26969.
IN NAME OF

CARTEE & NINA L. WOOD

Surveyed June 2, 1966., by *L. E. Gould*