

# T.36 S., R.3 W., W.M.

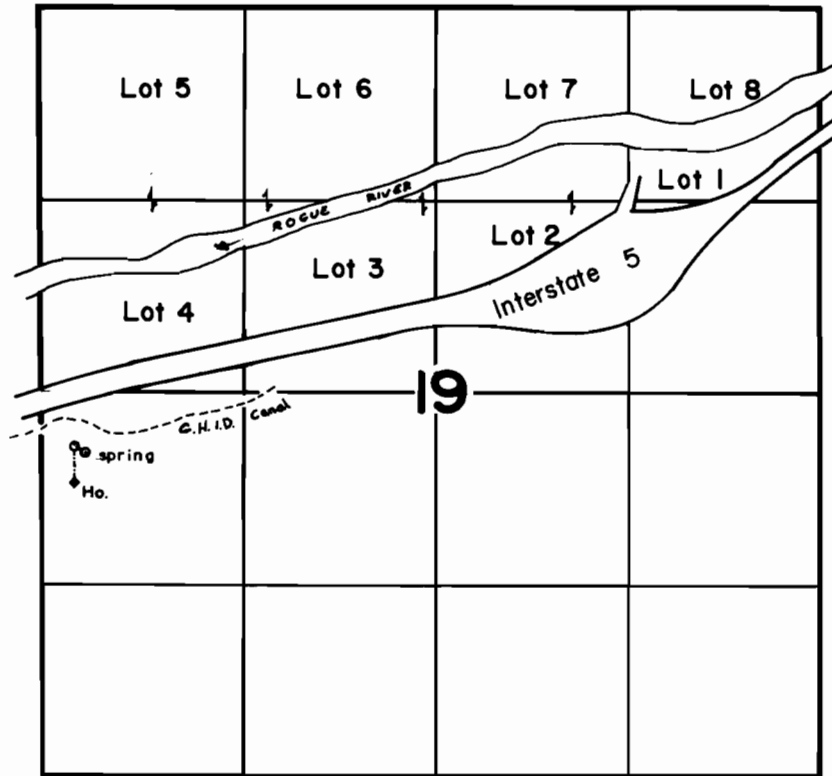

Spring: 390' S & 335' E from W 1/4 cor.

Scale 4" = 1 mile

## FINAL PROOF SURVEY UNDER

Application No. 528.75... Permit No. 399.03.....  
IN NAME OF

.....WARREN.....R.....BROTHERTON.....

Surveyed July...10,.. 1980., by B.R.SUND.....