

T. 38 S., R. 3 W., W.M

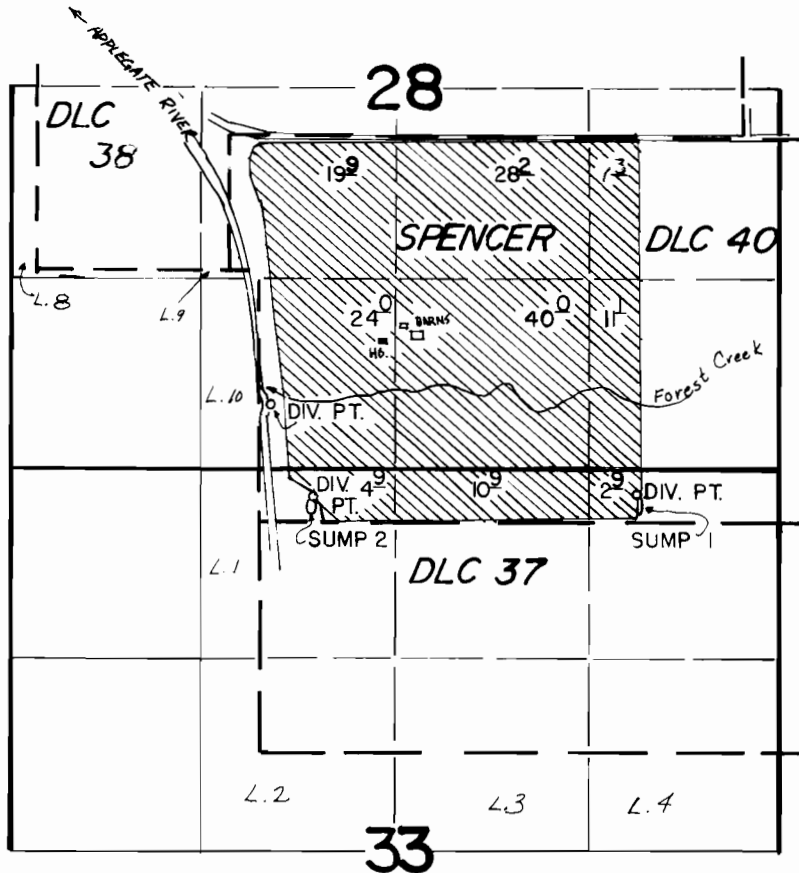

Applegate River - 440' N. & 850' W.
 Sump 1 - 180' S. & 1650' E
 Sump 2 - 180' S. & 550' W.
 ALL FROM S 1/4 COR. Sec. 28, T. 38 S., R. 3 W., W.M.

FINAL PROOF SURVEY UNDER

56649 44300
 G8479 G 7924

Application No. Permit No.
 IN NAME OF

DELBERT W. JONES II & /OR KATHERINE M. JONES

Surveyed JULY 14, 1983, by B. S. JAMES
 AUGUST 18, 1984