

# T. 38 S., R. 3 W., W.M

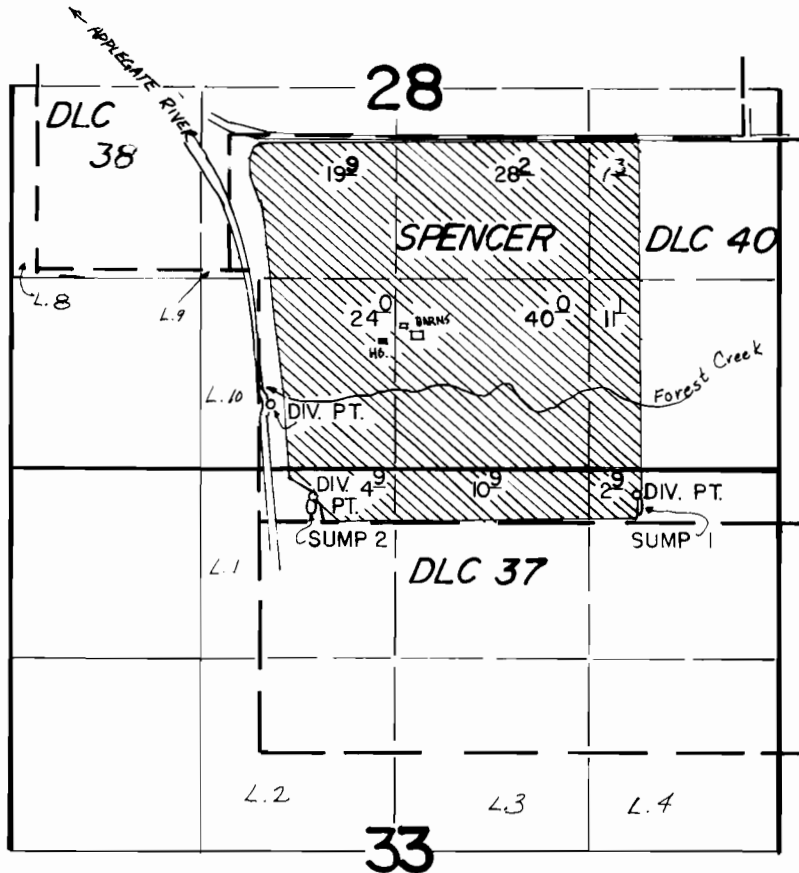

Applegate River - 440' N. & 850' W.  
 Sump 1 - 180' S. & 1650' E.  
 Sump 2 - 180' S. & 550' W.  
 ALL FROM S 1/4 COR. Sec. 28, T. 38 S., R. 3 W., W.M.

## FINAL PROOF SURVEY UNDER

56649                      44300  
 G8479                      G 7924

Application No. .... Permit No. ....  
 IN NAME OF

**DELBERT W. JONES II & /OR KATHERINE M. JONES**

Surveyed JULY 14, 1983, by B. S. JAMES  
 AUGUST 18, 1984