

T.38S., R.4W., W.M.

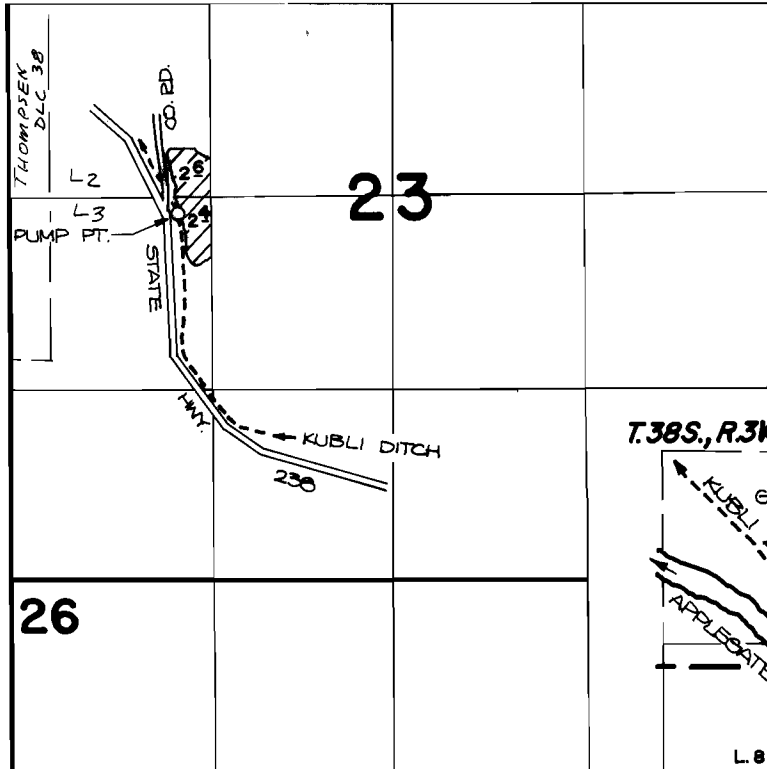

DIVERSION POINT IS LOCATED 2510'S. AND 3370'W. FROM THE N.E. CORNER OF G. LONG DLC 39, IN SECTION 30, T. 38S., R. 3W., W.M.

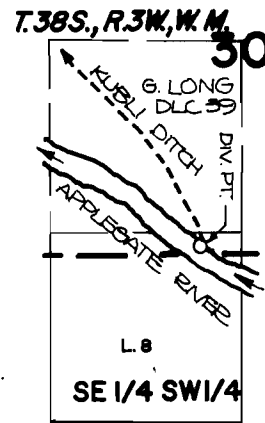

Scale 4" = 1 Mile

FINAL PROOF SURVEY UNDER

Application No. 62131.... Permit No. 45960....
IN NAME OF

.....WILLARD E. MARSH.....

Surveyed April 6, 1982, by Bruce R. Sund