

T.9S., R.40E., W. M.

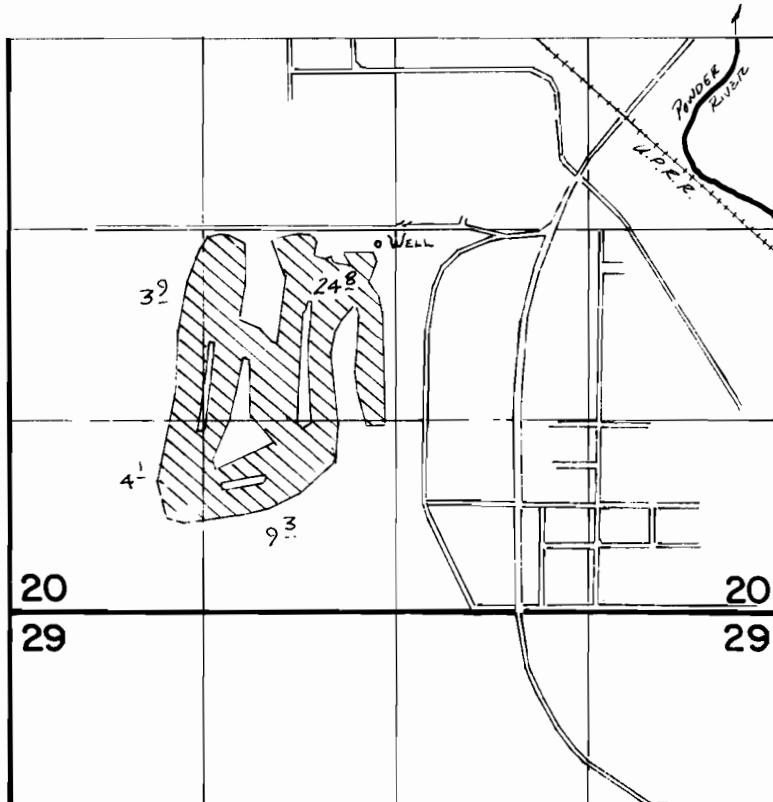

WELL LOC: 100'S. & 100'W. FROM CENTER SEC 20

**FINAL PROOF SURVEY**  
UNDER

Application No. **G-8510** Permit No. **G-7830**  
IN NAME OF

.....**THE CITY OF BAKER**.....

Surveyed *Dec 11* 19*81*, by *J.H. Church*