

T. 4N., R. 29E., W. M.

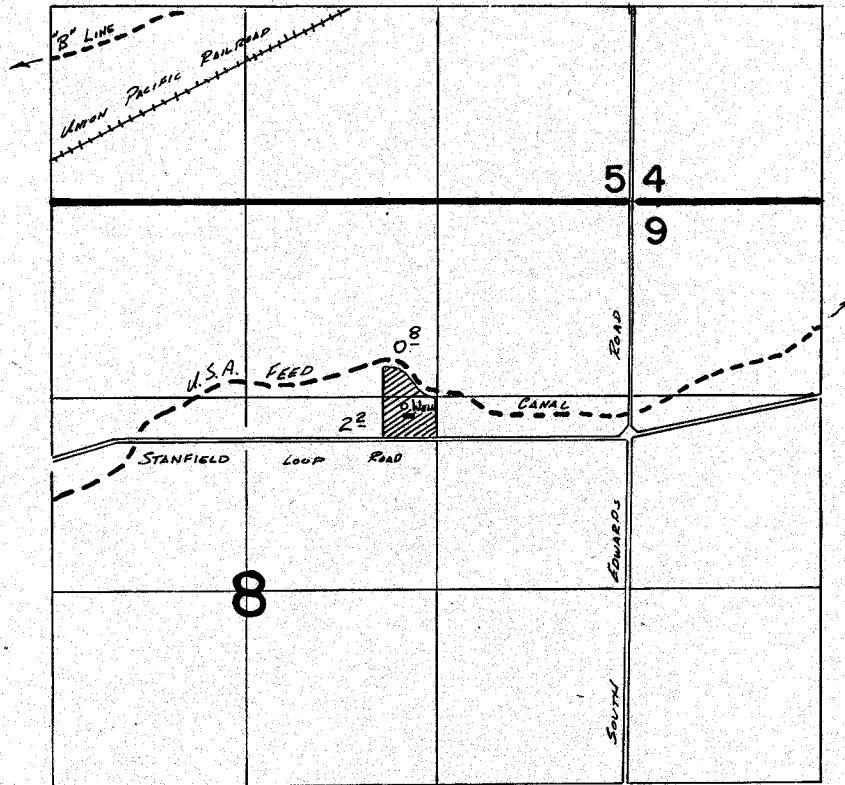

WELL LOCATED 1400'S. & 1550'W. FROM NE COR. SEC 8

**FINAL PROOF SURVEY**  
UNDER

Application No. G:8266. Permit No. G:7613.....  
IN NAME OF

.....THOMAS P. DAVIDSON.....

Surveyed May 20..... 1983, by V.L. Church.....