

T. 6N., R. 35E., W.M.

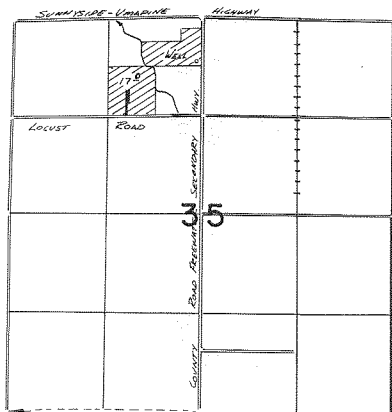

WELL LOC: 600'S. & 80'W. FROM N¹/₄ COR. SEC 35

FINAL PROOF SURVEY
UNDER

Application No. G:8367 Permit No. G:7748
IN NAME OF

ROBERT W. LEIBBRAND

Surveyed Aug. 16, 1982, by V.L. COURCH