

G 9306
55020

T. 6N., R. 35E., W.M.

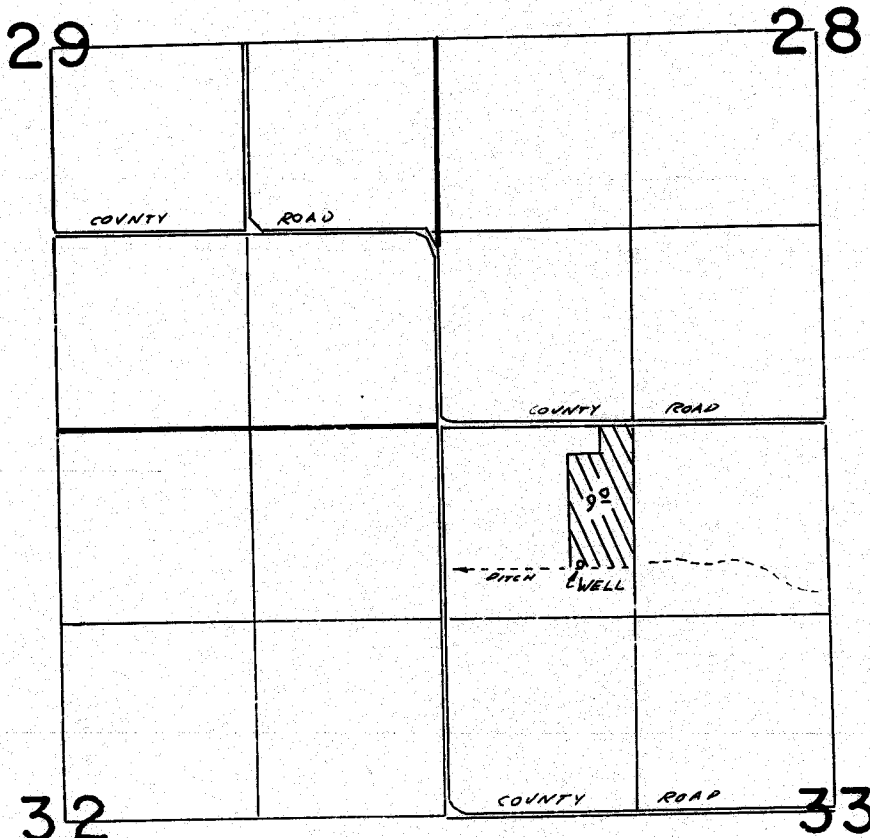

WELL LOCATED 960'S. 1950'E FROM NW COR. SEC. 33

SCALE 1" = 1320'

FINAL PROOF SURVEY UNDER

Application No. G-9897 Permit No. G-9306
IN NAME OF

ELBERT A. FRY

Surveyed Sept 14, 1981 by Hanson, R. Church
April 17, 1986

REV. 7-17-86 VCC 254L

NW 1/4 NW 1/4
P15-1982-PA
NE-SMM-11