

T. 2S., R. 44E., W.M.

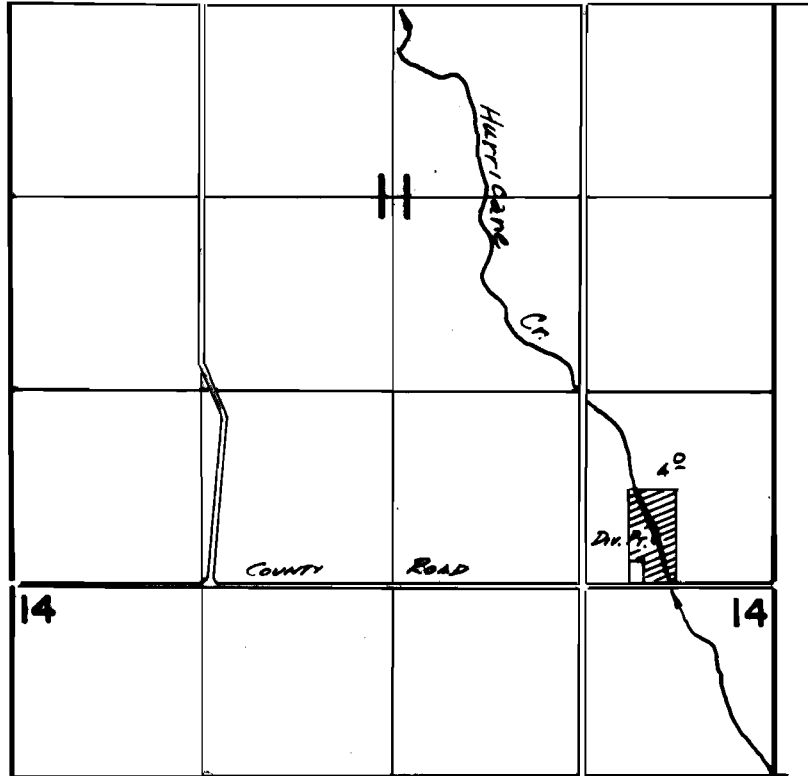

*Dir. Pt. Loc: 300' N. & 820' W. FROM SE COR. SEC 11*

**FINAL PROOF SURVEY**  
UNDER

Application No. **55825** Permit No. **41886**  
IN NAME OF

**GARY W. WITHERITE**

Surveyed *Aug. 11* 19*82*, by *V.L. Church*