

T.I.S., R.43E., W.M.

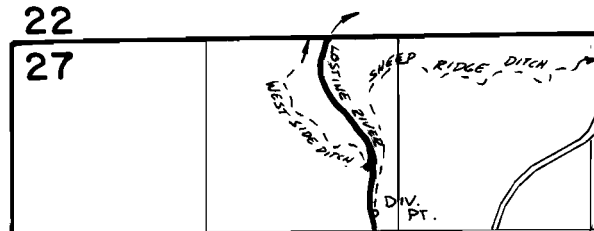
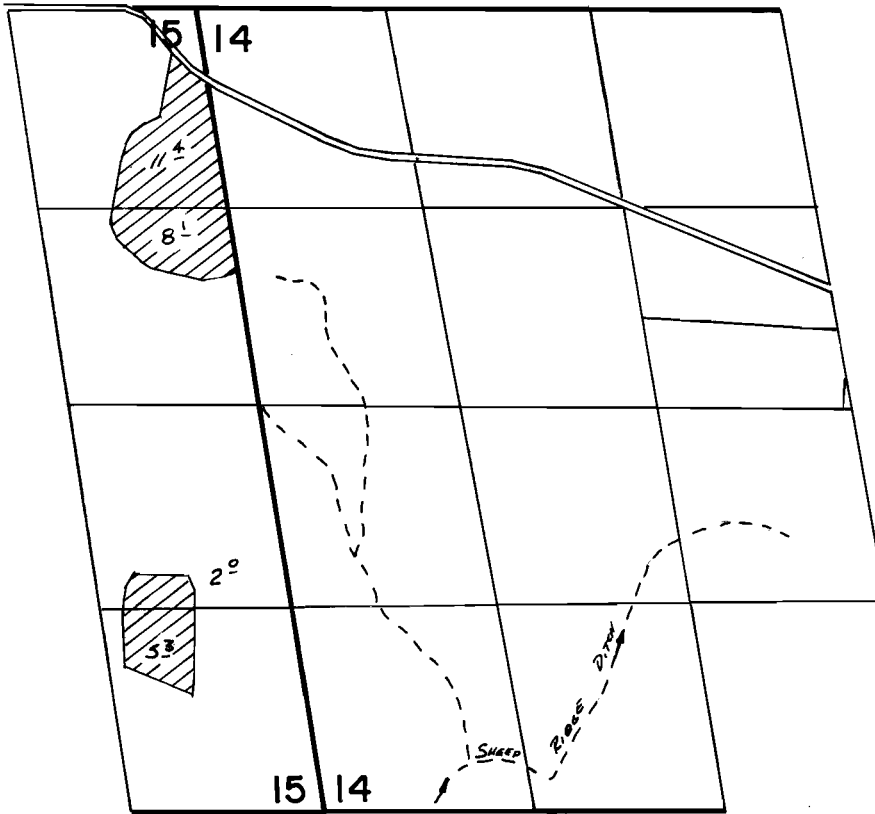

Div. Pt. loc: 1200 S of 120 W. From S 1/4 Cor. Sec 22

**FINAL PROOF SURVEY**  
UNDER

Application No. 58814 Permit No. 44569  
IN NAME OF

RICHARD H. HAGENAH

Surveyed Aug 10 1982, by V.L. Church