

# T. 4S.R. 12 E.W.M.

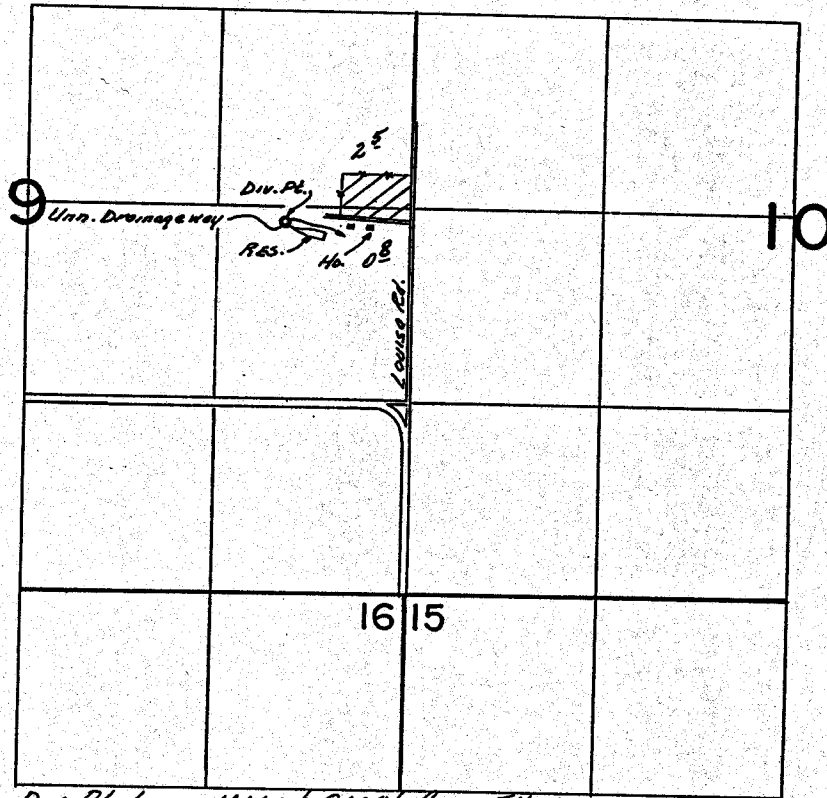

Div. Pt. Loc. - 100' S of 860' W. from E 1/4 Cor. Sec. 9

## FINAL PROOF SURVEY UNDER

R-53960                      R-6461  
Application No. 53013..... Permit No. 40446...  
IN NAME OF

KARL BLOIS

Surveyed Sept. 11... 1979, by C.R. RODRIGUEZ.