

T.3S.R.1E.W.M.

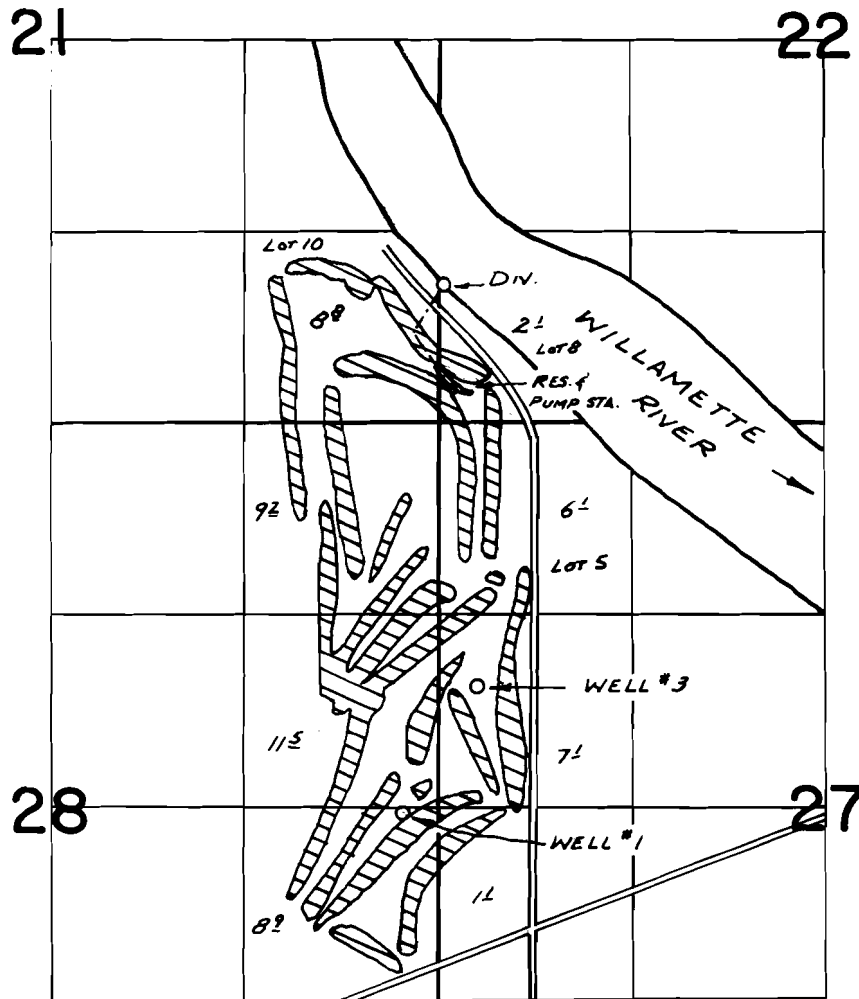

DIV. PT. LOC: 950' N. & 30' E., WELL #1 - 2700' S. & 240' W.,
 WELL #3 - 1830' S. & 270' E., ALL FROM N.W. COR. SEC. 27

FINAL PROOF SURVEY

UNDER

Application No. G-7544 54724 Permit No. G-6878 - SUPPLEMENTAL
40993 - PRIMARY
 IN NAME OF

WILLAMETTE VALLEY COUNTRY CLUB

Surveyed MAR. 20 1980, by R. MUCKEN