

T. 3S., R. 1W., W.M.

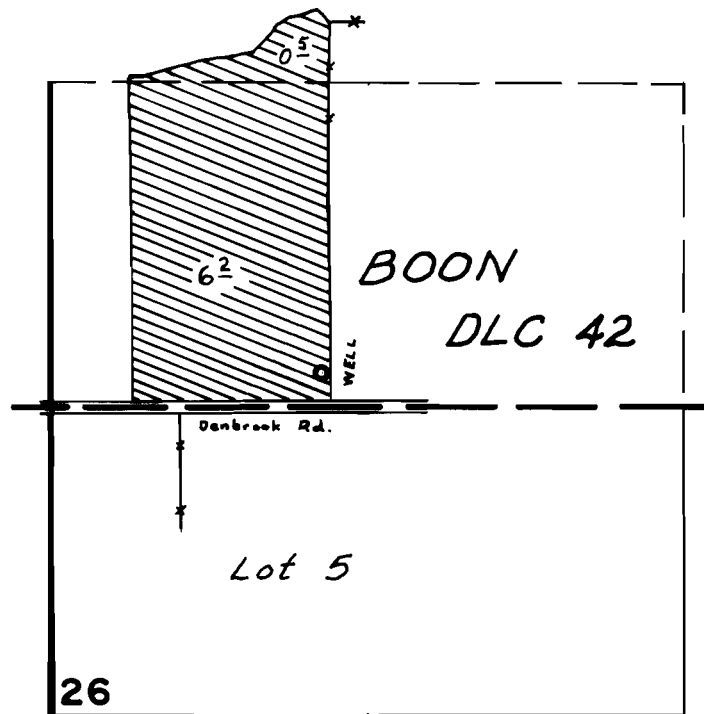

Well Loc: 720' N. $\frac{1}{2}$ 570' E. fr. S.W. Cor. Sec. 26

SCALE: 1" = 400'

FINAL PROOF SURVEY
UNDER

Application No. G-9650 Permit No. G-9535
IN NAME OF

LEE H. & MARION B. THOMPSON

Surveyed NOV. 10 1983, by L. TOLL

Sheet 1 of 2

PTS-1983-X
GEC