

T.5S., R.1E., W.M.

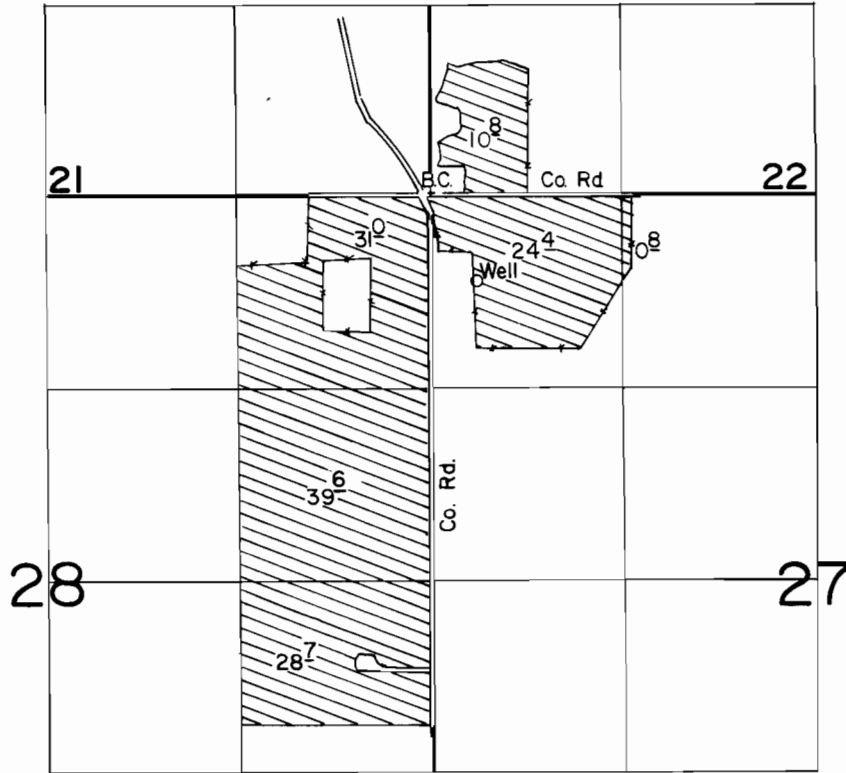

Well Loc. : 590' S. & 310' E. from NW Cor. Sec. 27.

Scale : 1" = 1320'

FINAL PROOF SURVEY UNDER

Application No. G-10309. Permit No. G-9318.....

IN NAME OF

IVAN KROPF

Surveyed JUNE 19, 1985, by T. Warren.....