

T.27S., R.17E., W.M.

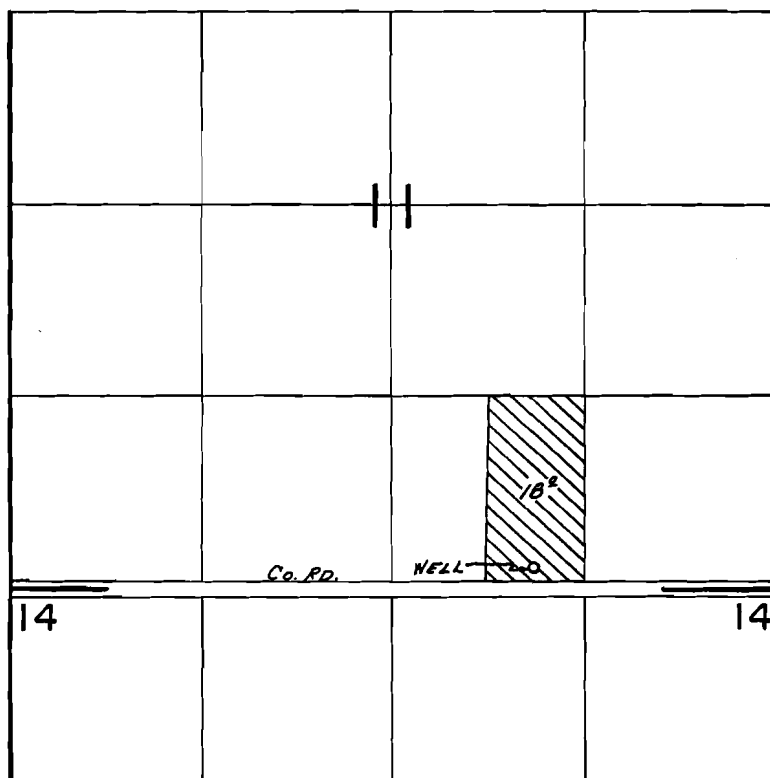

WELL LOC.: 150' N. & 1650' W. FROM SE COR. SEC. 11.

SCALE: 1"=1320'

FINAL PROOF SURVEY
UNDER

Application No. G:11091. Permit No. G:10238....
IN NAME OF

DAVID F. & ROSELLA F. HALFORD

Surveyed Sept. 13, 1985, by B.W. BISHOP....