

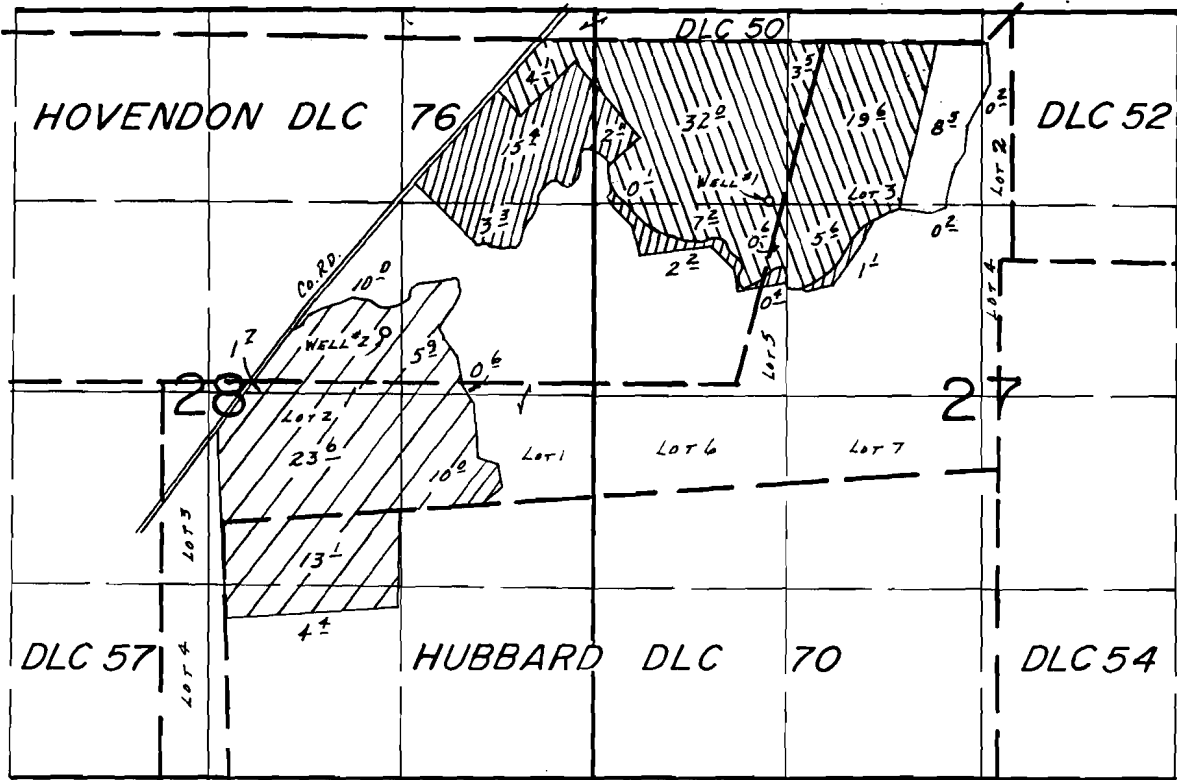



T. 4S., R. 1W., W.M.



WELLS LOC.: #1- 1340'N. & 1450'N FROM CENTER SEC. 27, #2- 430'N & 1200'E FROM CENTER SEC. 28.

-  Primary Well No. 2
-  Primary Well No. 1 with any deficiency supplied from Well No. 2
-  Supplemental Well No. 2

SCALE: 1" = 1320'

FINAL PROOF SURVEY
UNDER

Application No. G-9233. Permit No. G-8563....
IN NAME OF

.....JAMES BUTSCH.....

Surveyed Mar. 21.... 19.86, by T.M. WARREN....