

T. 6 S., R. 3 W., W.M.

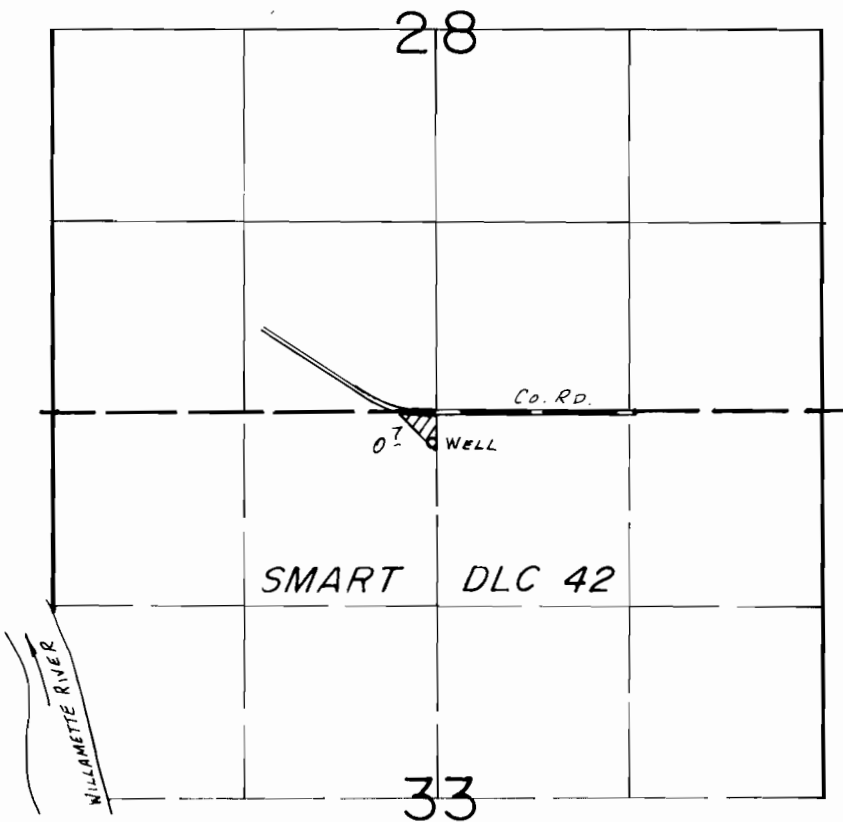

WELL LOC.: 200'S. & 30' W. FROM N. 1/4 COR. SEC. 33.

SCALE: 1" = 1320'

### FINAL PROOF SURVEY UNDER

Application No. G-10432 Permit No. G-9607.....  
IN NAME OF

.....MICHAEL G. ELLS.....

Surveyed Mar. 31.... 19.86, by T.M. WARREN.....

4/16/86  
BWB