

T. 9S., R. 4W., W.M.

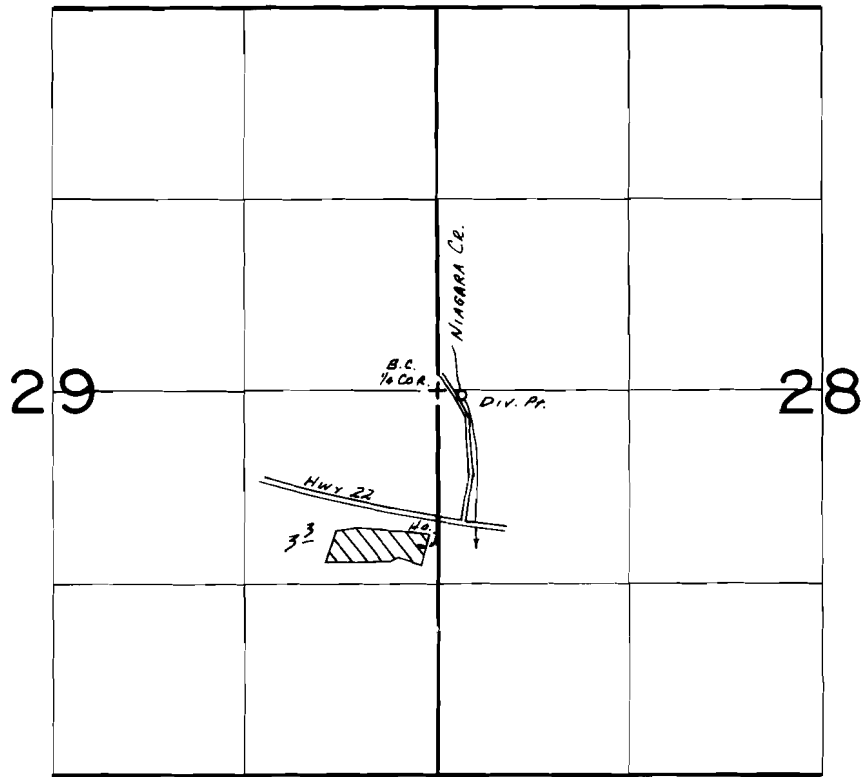

DIV. PT. LOCATED 30'S. & 150'E. FROM WEST 1/4 CORNER SECTION 28

FINAL PROOF SURVEY
UNDER

Application No. 57557... Permit No. 43311.....
IN NAME OF

.....DAVID H. BARNHARDT.....

Surveyed APR. 30. 19.80. by C.L. HUGHES.....