

T9S R2W WM

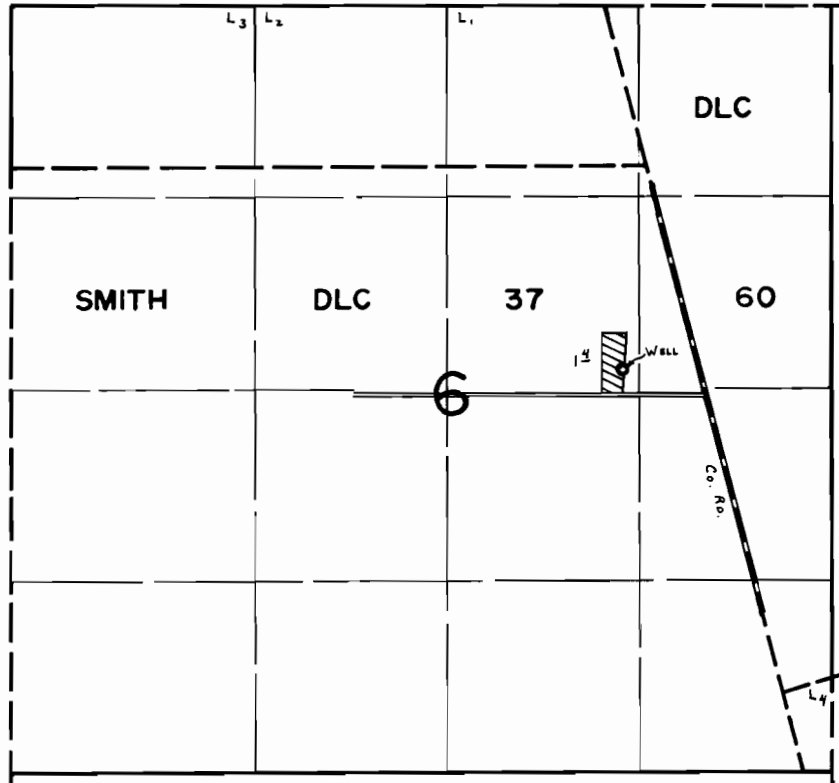

WELL Loc: 1400' S. & 160' W. fr. N.E. Cor. SMITH D.L.C. 37.

FINAL PROOF SURVEY UNDER

Application No. ~~G-9348~~ Permit No. ~~G-8636~~
IN NAME OF

.....MYRTLE H. SPRONG.....

Surveyed APR. 21. 19.80., by C. L. HUGHES.....