

T.38S., R.4W., W.M.

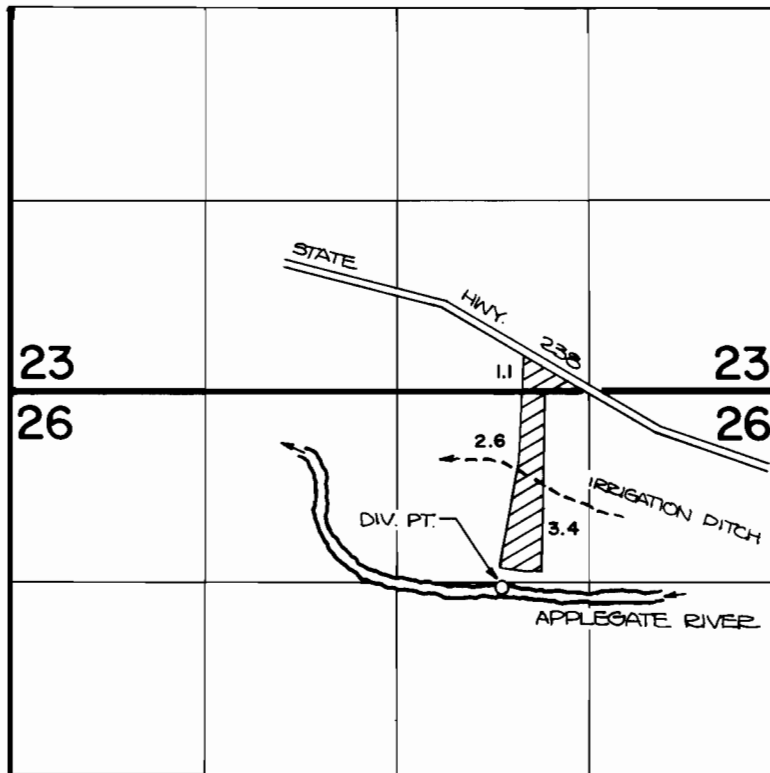

THE DIVERSION POINT IS LOCATED 1380' S. AND 1950' W.
FROM THE NORTHEAST CORNER OF SECTION 26.

FINAL PROOF SURVEY UNDER

T- 4256

Application No. 58931 44431
62053 Permit No. 45951.....

IN NAME OF

THOMAS J. AND/OR GRACE M. SMITH

Surveyed April...1, 1982, by Bruce...R. Sund