

T. 36 S., R. 3 W., W.M.

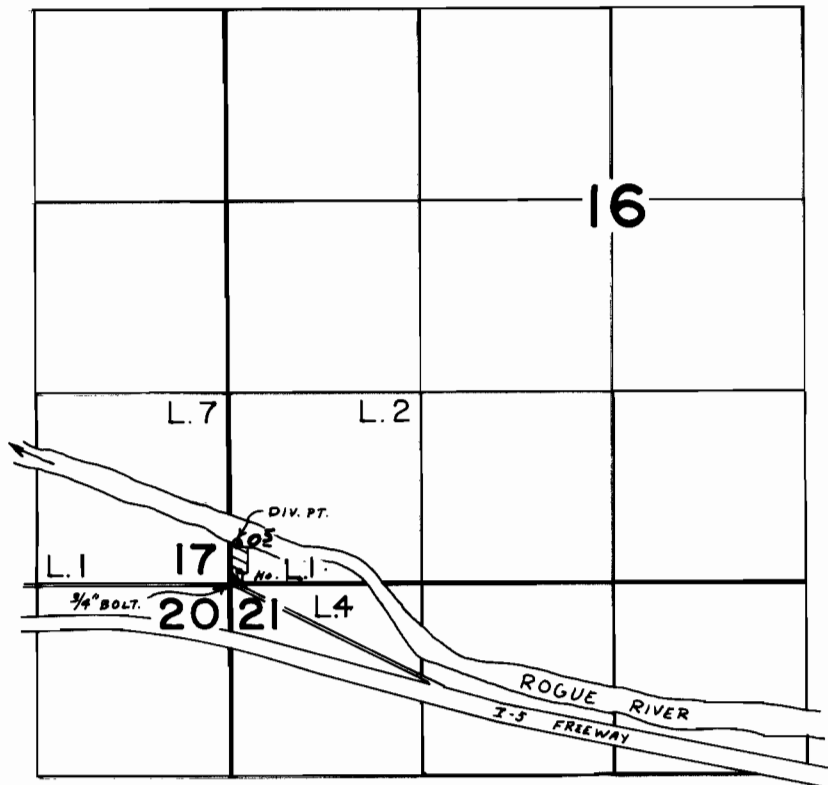

DIV. PT. : 270' N ; 50' E FROM THE SW CORNER OF SEC. 16.

SCALE : 4" = 1 MILE

**FINAL PROOF SURVEY**  
UNDER

Application No. 58962. Permit No. 44432...  
IN NAME OF

MICHAEL R. and/or LINDA REMINGTON

Surveyed NOV. 17, 1981, by Bruce R. Sund