

T.39 & 40S., R.3W., W.M.

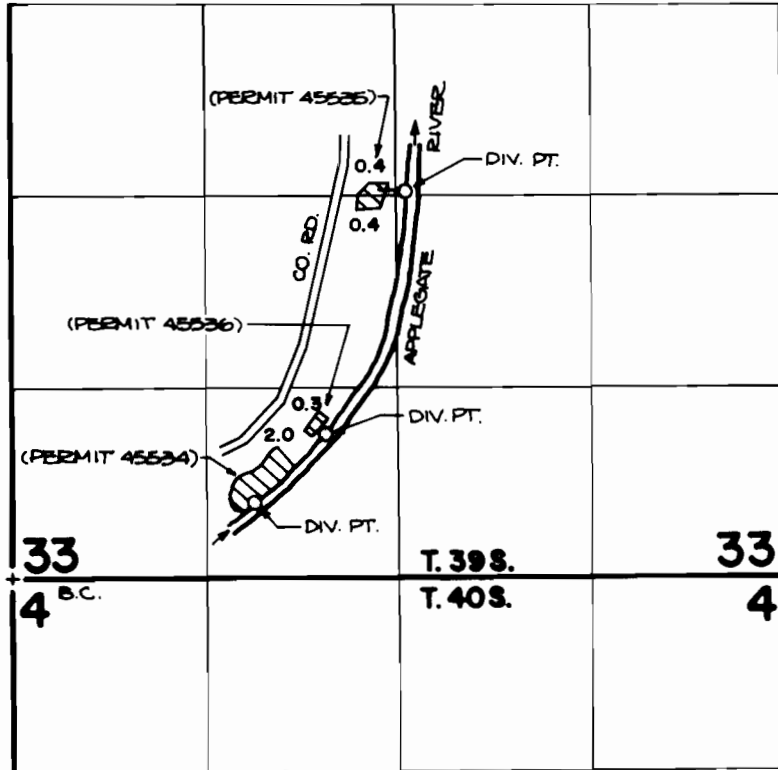

DIV. PT. (PERMIT 45535) LOC: 2640' N. AND 2690' E.;
 DIV. PT. (PERMIT 45536) LOC: 990' N. AND 2140' E.;
 DIV. PT. (PERMIT 45534) LOC: 510' N. AND 1660' E.;
 ALL FROM THE S.W. CORNER OF SECTION 35.

FINAL PROOF SURVEY UNDER

60447 45536
 60446 45535

Application No. 60305.. Permit No. 45534.....

IN NAME OF

LEE & MARGARET MYERS

Surveyed MAY 18... 1982., by B. SUND.....