

T.38 S., R. 3 W., W.M.

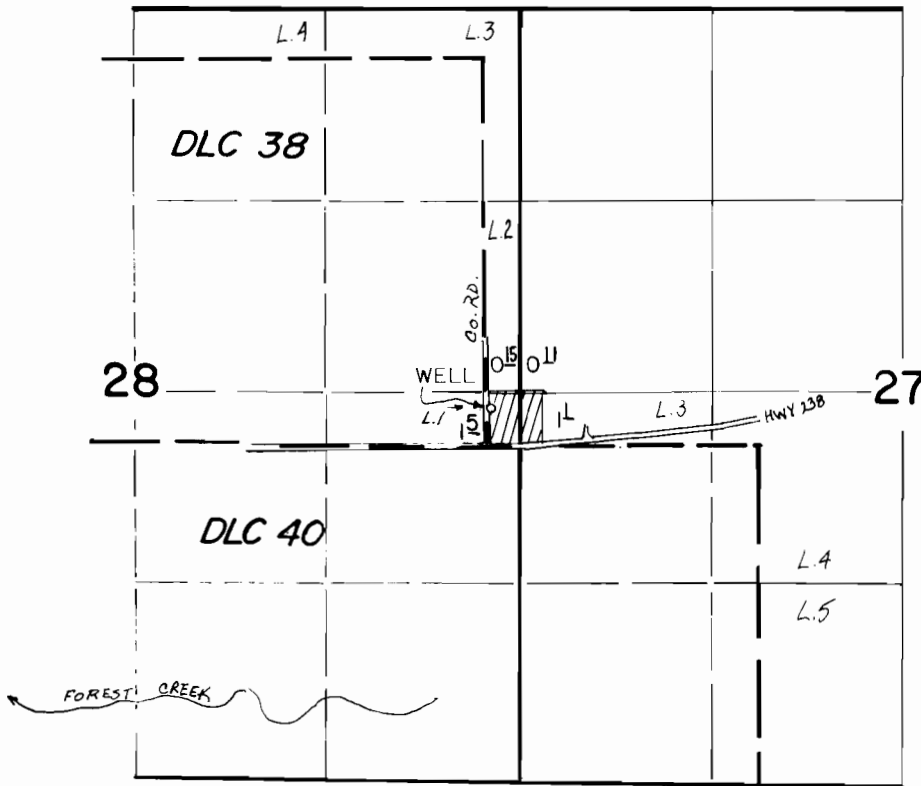

WELL LOCATED 100' S. & 200' W. OF
EAST 1/4 COR. SEC. 28.

FINAL PROOF SURVEY UNDER

Application No. G.8.417. Permit No. G.77.73.....
IN NAME OF

MERLE F. &/OR BETTY WORKMAN

Surveyed APRIL 21, 1982, by B. R. SUND.....