

T. 38 S., R. 8 W., W.M.

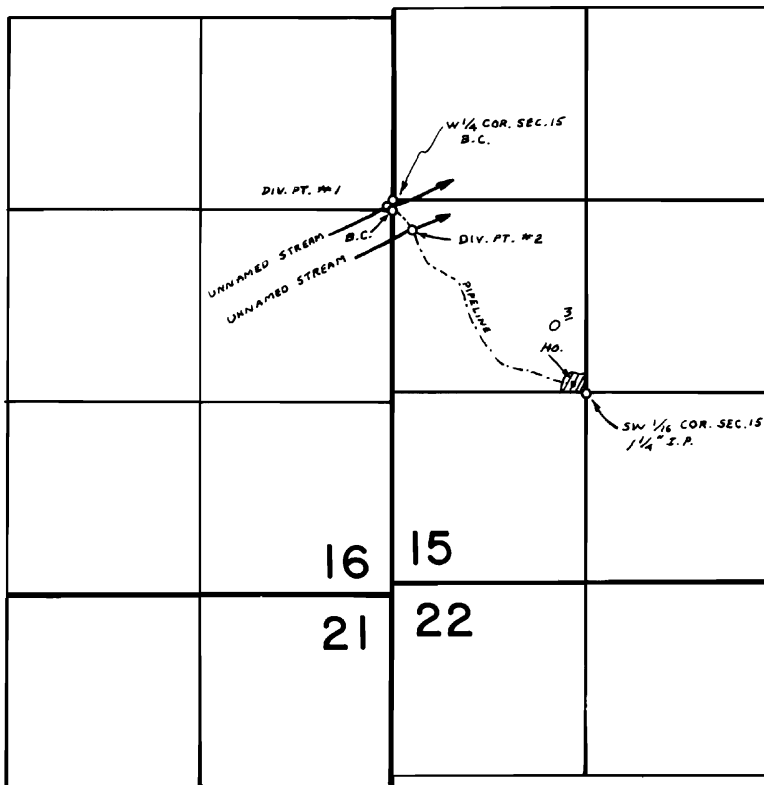

DIV. PT. #1 : 40'S & 40'W FROM W 1/4 COR. SEC. 15
 DIV. PT. #2 : 200'S & 130'E FROM W 1/4 COR. SEC. 15

FINAL PROOF SURVEY UNDER

Application No. 49543 Permit No. 37081
 IN NAME OF

PHILIBERT CONSTANT SEYDEL

Surveyed JUL. 28 1978 by B. SUND
NOV. 7 1984 J. R. WOODROOF