

T. 13S., R. 31E., W.M.

RECEIVED

OCT 5 1983

APPLICATION MAP FOR
DANNY & JANICE ELLISON

WATER RESOURCES DEPT.
SALAS, UTILITY

Application No. ⁶⁹³⁵¹ SECTION 35
Permit No. 48158

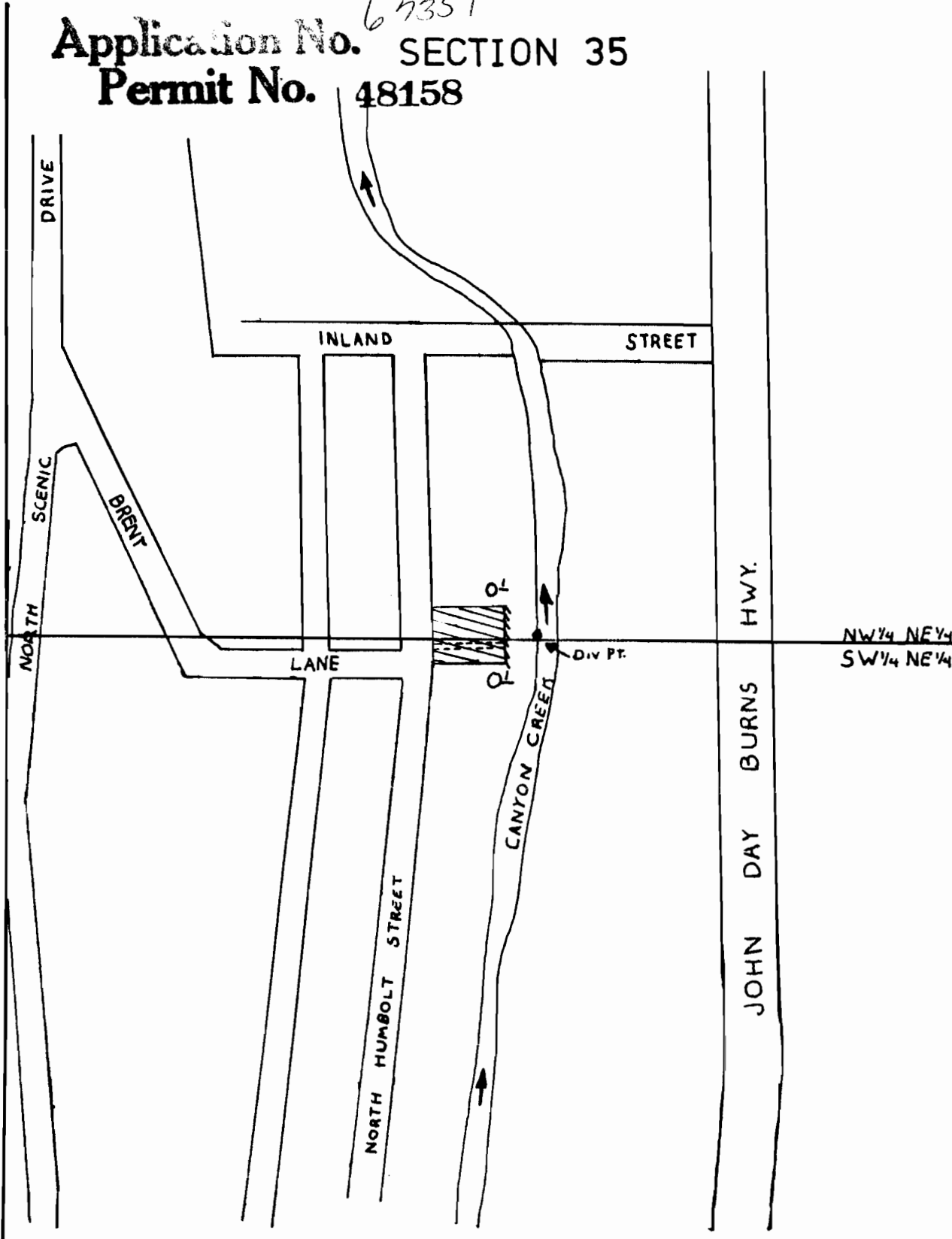

SCALE
1" = 200'

Div. Pt. - is located 585' West and 10' North of the Center $\frac{1}{4}$ Cor. of the NE $\frac{1}{4}$

NW $\frac{1}{4}$ NE $\frac{1}{4}$
SW $\frac{1}{4}$ NE $\frac{1}{4}$

Center $\frac{1}{4}$ of NE $\frac{1}{4}$